

Homer L. McKenzie, et al
1.25 Ac.

446.0'

John R. & Nancy C. Burchett
1.51 Ac.
Lot No. 28

REFERENCE

Area surveyed being a portion
of two 1.25 Acre Parcels as
conveyed to James R. Boggs
& Irene F. Boggs as recorded
in Deed Book No. 196, Page 224,
225 & 226 of the Madison
County, Ohio records.

CERTIFICATION

I hereby certify that this plat was prepared
from an actual survey of the premises.
Also, that no encroachments exist, and that
the building shown is located entirely
within the property lines. Also, that no
encroachments exist from adjoining
property.

Lowell W. Probasco
Reg. Surveyor No. 2496

SURVEY OF 0.611 AC. TRACT
LOCATED AT
No. 6000 NORTH ROAD*
JEFFERSON TWP., MADISON CO., O.
Scale: 1" = 40' Sept. 1975
— SURVEYED FOR —
MR. JAMES R. BOGGS

1.25 Ac.
V.M.S. 2985

James R. Boggs et al
Lot No. 26-B
Parcel No. Two

1.25 Ac.
VMS 2985

James R. Boggs et al
Lot No. 26-A
Parcel No. One

0.611 Ac.

(0.2382 Ac.)

(0.3724 Ac.)

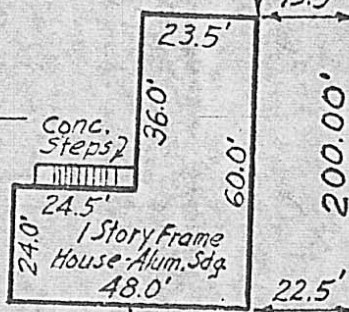

N. 55° 02' E.

133.00'

57.3'

200.00'

N. 34° 58' W

200.00'

S. 34° 58' E

200.00'

446.0'

133.00'

213.52'

446.0'

North Line of NORTH ROAD

NORTH ROAD 30'

Iron Pin

Iron Pin

Iron Pin
(found)

Iron Pin
(found)

James W. Skidmore et al
1.19 Ac. D.B. 200, P. 233

122'

122'

122'

122'

Easement for Road - 12' wide

20'

99.48' BEGIN R.R. Spike S. 55° 02' W. R.R. Spike
1436.82' to & Taylor-Blair Road
(measured along north line of road)

HARVEY & PROBASCO
Registered Engineers & Surveyors

Lowell W. Probasco
Registered Surveyor No. 2496

* Area also known as "SIEBOLD ADDITION"

300