

DEED REFERENCE

WILLIAM C & EMILY P BAUERLE, REVOCABLE LIVING TRUST 1/2 &
 CHRISTINE WEBB & EMILY P BAUERLE, CO TRUSTEE 1/2
 OR 251 PG 76
 79.457 ACRES

PARCEL No.24-00067.000
 104.90 ORIG. ACRES
 FOURTH TRACT

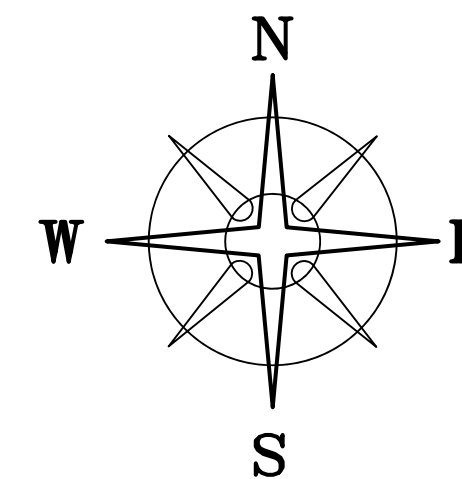

BEARINGS ARE BASED ON A
 GPS OBSERVATION ON 06/22/18
 WGS 1984 GEODETIC NORTH.

NOTE

VMS LINES SCALED FROM GIS

LOCATION MAP

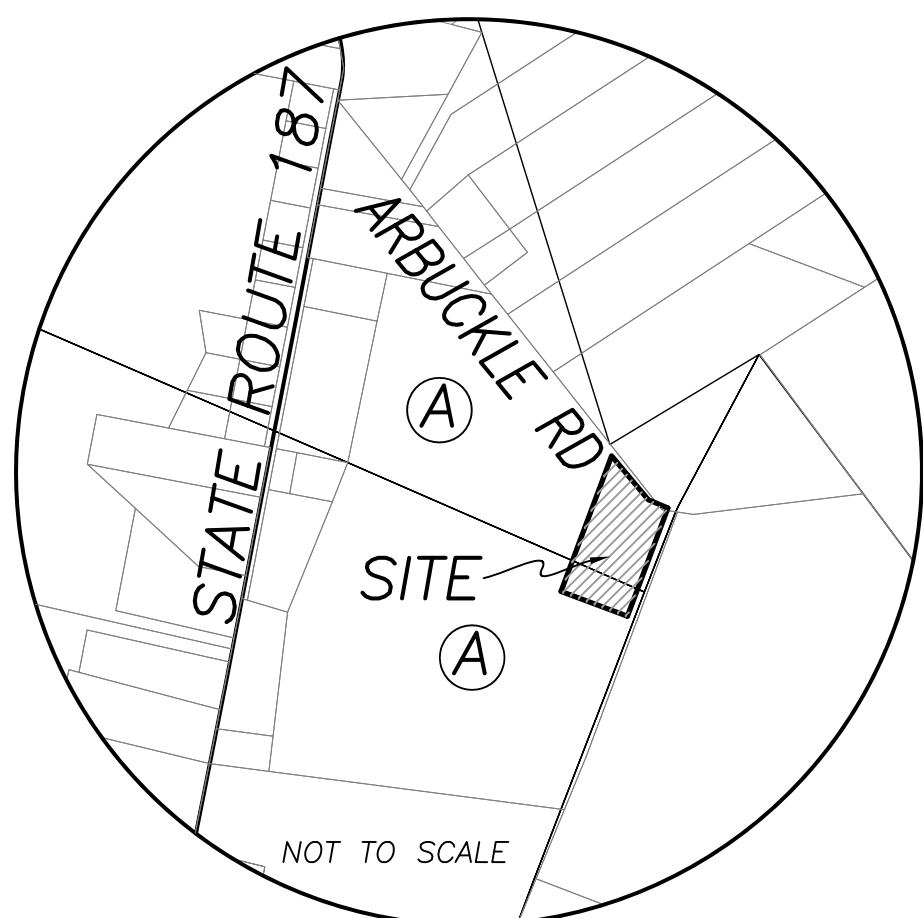

LEGEND

- ALL MONUMENTS FOUND OR SET ARE IN GOOD CONDITION UNLESS OTHERWISE NOTED.
- ☐ MONUMENT BOX (FOUND)
- ⊙ 3/4" Ø IRON PIPE (FOUND)
- IRON PIN (FOUND)
- 5/8" Ø IRON PIN (FOUND)
- ⊠ MAG NAIL (FOUND)
- ⦿ MAG NAIL (SET)
- ⊙ 5/8" Ø REBAR & YELLOW PLASTIC CAP STAMPED "COTTRILL 6858" (SET)

WILLIAM C & EMILY P BAUERLE
 OR 251 PG 76
 68.14 ORIG. ACRES
 FIFTH TRACT

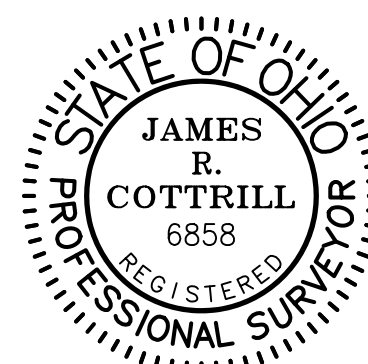

I HEREBY CERTIFY THAT THIS PLAT DEPICTS AN ACTUAL FIELD SURVEY PERFORMED BY JAMES R. COTTRILL, P.S. #6858

James R. Cottrill DATE: 07/02/18

COTTRILL SURVEYING, INC
 8256 State Route 207 NE, Mt. Sterling, Ohio 43143
 Office: (740) 869-3811 Fax: (740) 869-3846
 www.cottrillsurveying.com

**5.0001± ACRES,
 VMS 6014 & 12916, SOMERFORD TWP,
 MADISON COUNTY, STATE OF OHIO.
 SURVEYED FOR BOB ERNST**

SCALE : 1" = 100'	JOB No. S180604	CREW: MW
100' 50' 0 100'	SURVEYED 06/2018	DWN BY: RC,NC
	DRAWN 06/2018	CHECK: NC

COTTRILL SURVEYING, INC

8256 State Route 207 NE, Mt. Sterling, Ohio 43143, Ph. 740.869.3811, www.cottrillsurveying.com

5.0001 Acre Tract Surveyed for Bob Ernst

The following described 5.0001 acre tract is situated in the State of Ohio, Madison County, Somerford Township, VMS 6014 and 12916, being part of a 79.457 acre tract (Parcel 24-00067.000, Fourth Tract, 104.90 original acres) conveyed to William C and Emily P Bauerle, Revocable Living Trust (1/2) and Christine Webb and Emily P Bauele, Co-Trustee (1/2) by Official Record 251 page 76, and being more particularly described as follows:

Commencing at a monument box found at the centerline intersection of Arbuckle Road (County Road 110, 40 feet right-of-way) and State Route 187 (60 feet right-of-way);

Thence, with the centerline of Arbuckle Road with the following two courses:

- 1) South 38° 55' 11" East, a distance of 1231.64 feet to an iron pin found at the North corner of said 79.457 acre tract;
- 2) South 38° 52' 36" East a distance of 1012.88 feet to a mag nail set at the **True Point of Beginning**;

Thence, continuing with the centerline of Arbuckle Road with the following two courses:

- 1) **South 38° 52' 36" East** a distance of **281.15 feet** to an iron pin and cap set;
- 2) **South 65° 58' 49" East** a distance of **105.73 feet** to an iron pin and cap set;

Thence, across said 79.457 acre tract with the following three new courses:

- 1) **South 21° 33' 18" West**, passing an iron pin and cap set at 46.74 feet, a total distance of **569.69 feet** to an iron pin and cap set;
- 2) **North 68° 26' 42" West** a distance of **350.17 feet** to an iron pin and cap set;
- 3) **North 21° 33' 18" East**, passing iron pin and cap set at 688.15 feet, a total distance of **712.98 feet** returning to the **True Point of Beginning**, containing **5.0001 Acres** more or less.

Bearings are based on a GPS observation on June 22, 2018, WGS 1984 Geodetic North.

This deed is subject to and with the benefit of all legal highways, restrictions, easements, limitations, and reservations, of record, if any and to zoning restrictions which have been imposed thereon, if any.

All iron pins set are 5/8-inch diameter rebar with yellow plastic cap stamped "Cottrill 6858."

This description is based on a field survey performed June 22, 2018 by James R. Cottrill, PS registration #6858. (Job #S180604-5-0001AC)

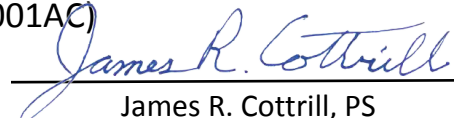

James R. Cottrill, PS