

LOCATION MAP

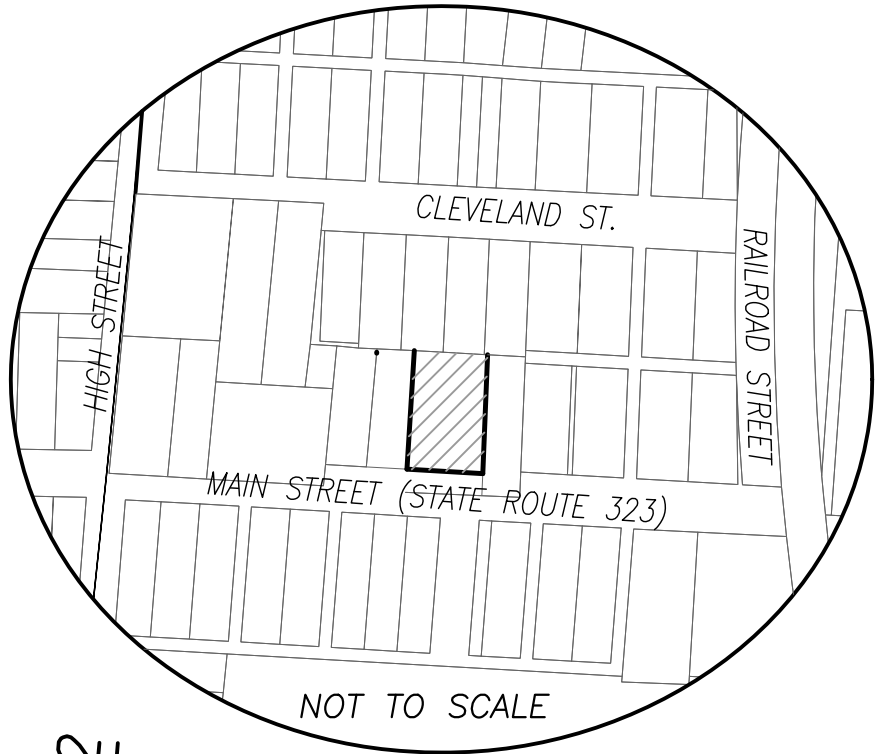

DEED REFERENCE
ORANGE CAPITAL FUNDING, LLC
OR 327 PG 593
 PARCEL No. 28-00068.000
(A) 0.34 ACRES

BEARINGS ARE BASED ON A
 GPS OBSERVATION ON 10/20/17
 WGS 1984 GEODETIC NORTH.

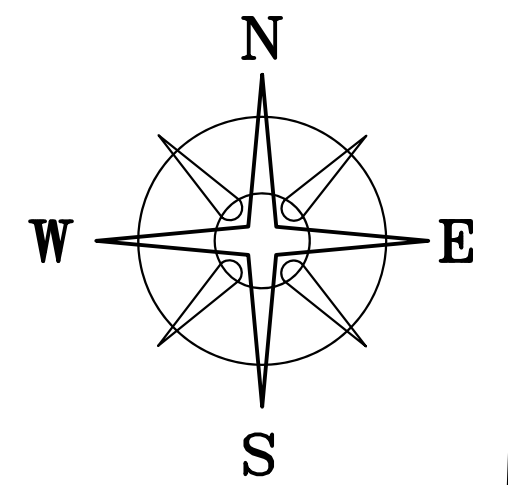

JAMES R FORD
 OR 302 P 1377
 0.184 ACRES
 28-00078.000

ELLA A ROBINSON
 OR 328 PG 1
 0.193 ACRES

ALEX M BROHARD
 OR 282 P 216
 0.184 ACRES
 28-00136.000

JAMES R FORD
 OR 302 P 1377
 0.184 ACRES
 28-00077.000

VMS 3642
 VMS 8582
 HIGH STREET (50' WIDE)
 R/W

- LEGEND**
- ALL MONUMENTS FOUND OR SET ARE IN GOOD CONDITION UNLESS OTHERWISE NOTED.
- ▣ MADISON CO. MON. (FOUND)
 - ⊙ 1/2" Ø IRON PIN IN CONCRETE (FOUND)
 - 5/8" Ø IRON PIN (FOUND)
 - ⊕ 3/4" Ø IRON PIN & YELLOW PLASTIC CAP STAMPED "LOUIS GREEN" (FOUND)
 - ⊙ 5/8" Ø REBAR & YELLOW PLASTIC CAP STAMPED "COTTRILL 6858" (SET)
 - ⊕ 5/8" Ø REBAR & YELLOW PLASTIC CAP STAMPED "COTTRILL 6858" (PREVIOUSLY SET)

LEO & FRANCES
 BURRELL, JT LIVES
 OR 335 PG 342
 0.2180 ACRES

KENNETH D & JACKIE LYNN
 GLISPIE, JT LIVES
 OR 339 P 616
 0.1765 ACRES
 30-18

(A)
0.3315± ACRES

GARY L & MARY E
 BURBA, JT LIVES
 OR 323 P 346
 0.15 AC.

SHED

TPOB

POINT OF COMMENCEMENT

S 87°27'26" E 380.91'

N 87°27'26" W 52.50'

N 87°27'26" W 97.47'
 NORTH LINE OF MAIN STREET

N 89°00'40" W 385.29'

MAIN STREET (STATE ROUTE 323, 60' R/W)

SOUTH LINE OF MAIN STREET

JAMES CRAWFORD'S ADD.

MAD. MON. 02-007

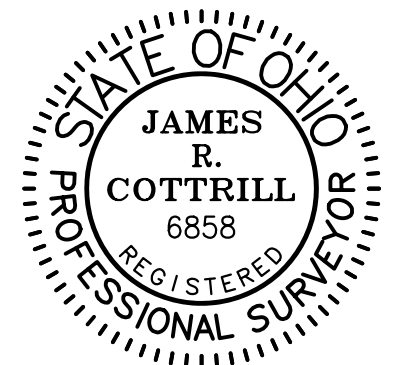

I HEREBY CERTIFY THAT THIS PLAT DEPICTS AN ACTUAL FIELD SURVEY PERFORMED BY JAMES R. COTTRILL, P.S. #6858
James R. Cottrill DATE: 08/01/18

COTTRILL SURVEYING, INC
 8256 State Route 207 NE, Mt. Sterling, Ohio 43143
 Office: (740) 869-3811 Fax: (740) 869-3846
 www.cottrillsurveying.com

0.3315± ACRES,
VMS 8582, VILLAGE OF SOUTH SOLON,
MADISON COUNTY, STATE OF OHIO.
SURVEYED FOR ORANGE CAPITAL FUNDING, LLC

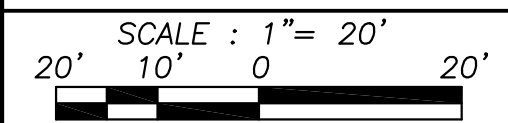

SCALE : 1" = 20'	JOB No. S180715	CREW: MW
20' 10' 0' 20'	SURVEYED 07/2018	DWN BY: RC
	DRAWN 07/2018	CHECK: NC

COTTRILL SURVEYING, INC

8256 State Route 207 NE, Mt. Sterling, Ohio 43143, Ph. 740.869.3811, www.cottrillsurveying.com

0.3315 Acre Tract *Surveyed for Orange Capital Funding, LLC*

The following described 0.3315 acre tract is situated in the State of Ohio, Madison County, Village of South Solon, VMS 8582, being all of a 0.34 acre tract (Parcel 28-00068.000) conveyed to Orange Capital Funding, LLC by Official Record 327 page 593, and being more particularly described as follows:

Commencing at the centerline intersection of Main Street (State Route 323, 60 feet right-of-way) and High Street (50 feet right-of-way);

Thence, with the centerline of Main Street, South 87° 27' 26" East a distance of 380.91 feet to a point;

Thence, North 03° 00' 32" East a distance of 30.00 feet to an iron pin and cap previously set at in the North line of Main Street at the Southeast corner of a 0.1765 acre tract conveyed to Kenneth D and Jackie Lynn Glispie, Joint Lives by Official Record 339 page 616 in the Southwest corner of said 0.34 acre tract and being the **True Point of Beginning**;

Thence, with the East line of said 0.1765 acre tract, **North 03° 00' 32" East**, passing an iron pin and cap previously set at 144.78 feet, a total distance of **149.78 feet** to the South line of a 0.184 acre tract conveyed to Alex M Brohard by Official Record 282 page 216;

Thence, with the South line of said 0.184 acre tract, **South 87° 48' 27" East**, passing the Southwest corner of a 0.184 acre tract conveyed to James R Ford by Official Record 302 page 1377 at 35.20 feet, passing the Southwest corner of a 0.184 acre tract also conveyed to James R Ford by Official Record 302 page 1377 at 89.36 feet, a total distance of **95.00 feet** to an iron pin and cap set at the Northwest corner of a 0.15 acre tract conveyed to Gary L and Mary E Burba, Joint Lives by Official Record 323 page 346;

Thence, with the West line of said 0.15 acre tract, **South 02° 03' 54" West** a distance of **150.36 feet** to an iron pin and cap set in the North line of Main Street;

Thence, with the North line of Main Street, **North 87° 27' 26" West** a distance of **97.47 feet** returning to the **True Point of Beginning**, containing **0.3315 Acres** more or less.

Bearings are based on a GPS observation on October 20, 2017, WGS 1984 Geodetic North.

This deed is subject to and with the benefit of all legal highways, restrictions, easements, limitations, and reservations, of record, if any and to zoning restrictions which have been imposed thereon, if any.

All iron pins set are 5/8-inch diameter rebar with yellow plastic cap stamped "Cottrill 6858."

This description is based on a field survey performed July of 2018 by James R. Cottrill, PS registration #6858. (Job #S180715-0-3315AC)

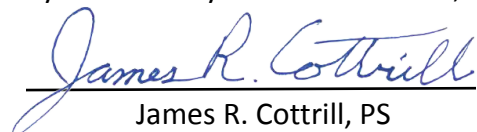
James R. Cottrill, PS

