

STATE OF OHIO PRISON FARM
DB 90 P 213
115 ACRES

BEARINGS ARE BASED ON A GPS OBSERVATION ON 6/29/15
WGS 1984 GEODETIC NORTH

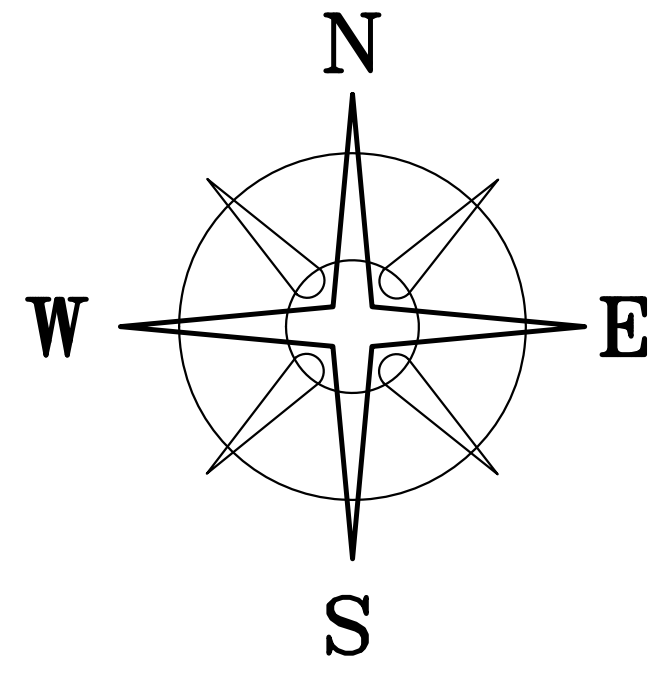

DEED REFERENCE

LEWIS L SIMPSON
OR 274 P 436
22.5 ACRES
29-00569.000

(A)

22.2206± ACRES

(A)

LEGEND

- ⊙ DOUBLE ANGLE IRON FENCE POST (FOUND)
- IRON PIPE (FOUND)
- ⊕ 3/4" IRON TEE BAR & CAP (FOUND)
- IRON PIN (FOUND)
- 12" SQ. CONCRETE FENCE POST (FOUND)
- △ 6"Ø CONCRETE R/W MONUMENT (FOUND)
- RAIL ROAD SPIKE
- P K NAIL
- ⊙ 5/8" Ø REBAR & YELLOW PLASTIC CAP STAMPED "COTTRILL 6858" (SET)

ALL MONUMENTS FOUND OR SET ARE IN GOOD
CONDITION UNLESS OTHERWISE NOTED.

CEMETERY TRUSTEES KIRKWOOD CEMETERY
23.694 ACRES
DB 35 P 73

STATE OF OHIO
HIGHWAY GARAGE
DB 90 P 213
5 ACRES

UNION TOWNSHIP
CITY OF LONDON

POB

US ROUTE 42

ROBERTS MILL ROAD
(TR 96)

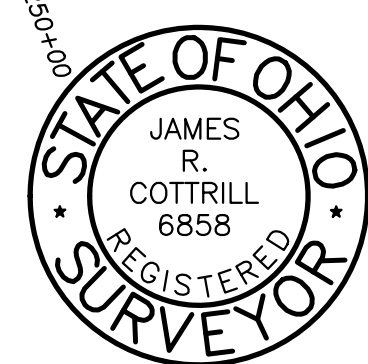

I HEREBY CERTIFY THAT THIS PLAT DEPICTS
AN ACTUAL FIELD SURVEY PERFORMED BY
JAMES R. COTTRILL P.S. #6858
DATE: 06/30/15

COTTRILL SURVEYING, L.L.C.
8256 S.R. 207 N.E. MT. STERLING, OHIO 43143 PH. (740) 869-3811

22.2206± ACRES, VMS 4513,
UNION TOWNSHIP,
MADISON COUNTY, STATE OF OHIO.
SURVEYED FOR SIMPSON

| | | |
|-------------------------|-------------------|-------------|
| DATE DRAWN: 06/30/15 | SCALE : 1" = 100' | CREW: MW |
| JOB # S150616 | 100' 50' 0 100' | DWN. BY: RC |
| F. B. # | | CK. BY: |

Cottrill Surveying, LLC

8256 State Route 207 NE, Mt. Sterling, Ohio 43143, Ph. (740)869-3811

22.2206 Acre Tract Surveyed for Simpson

The following described 22.2206 acre tract is situated in the State of Ohio, Madison County, Union Township, VMS 4513, and being all of a 22.5 acre tract (29-00569.000) conveyed to Lewis L Simpson by Official Record 274 page 436, and being more particularly described as follows:

Beginning at a point in the centerline of US Route 42 (right-of-way width varies) at the southwest corner of said 22.5 acre tract and the southeast corner of a 23.694 acre tract conveyed to Cemetery Trustees Kirkwood Cemetery by Deed Book 35 page 73, said point bears North 69° 00' 24" East a distance of 2425.76 feet and North 68° 53' 23" East a distance of 1014.33 feet from an iron pin found at the centerline intersection of said US Route 42 with Roberts Mill Road (Township Road 96);

Thence, with the east line of said cemetery **North 08° 34' 48" West**, passing an iron pin and cap set at 30.92 feet, also passing a double angle iron fence post found at 1337.25 feet, a total distance of **1338.79 feet** to an iron pin and cap set in the south line of a 115 acre tract conveyed to State of Ohio Prison Farm by Deed Book 90 page 213;

Thence, with the south line of said 115 acre tract, **South 87° 43' 07" East** a distance of **960.95 feet** to an iron pin and caps set at the northwest corner of a 5 acre tract conveyed to State of Ohio Highway Garage by Deed Book 90 page 213;

Thence, with the west line of said 5 acre tract, **South 04° 36' 48" West**, passing a 6 inch diameter concrete right-of-way monument found at 960.59 feet, a total distance of **1027.19 feet** to a point in the centerline of said US Route 42;

Thence, with the centerline of said US route 42, **South 68° 53' 23" West** a distance of **726.60 feet** returning to the point of beginning containing **22.2206 Acres** more or less.

Bearings are bases on a GPS observation on June 29, 2015, WGS 1984 Geodetic North.

This deed is subject to and with the benefit of all legal highways, restrictions, easements, limitations, and reservations, of record, if any and to zoning restrictions which have been imposed thereon, if any.

All iron pins set are 5/8 inch diameter rebar with yellow plastic caps stamped "Cottrill L.L.C. 6858."

This description is based on a field survey performed June 30, 2015 by James R. Cottrill registration #6858. (Job #S150616-22-2206AC)

James R. Cottrill, PS