

BEARINGS BASED ON THE NORTH LINE OF BROAD STREET (S 89°50'E)
AS SHOWN ON SLIDE #200 MOORESVILLE ADD.

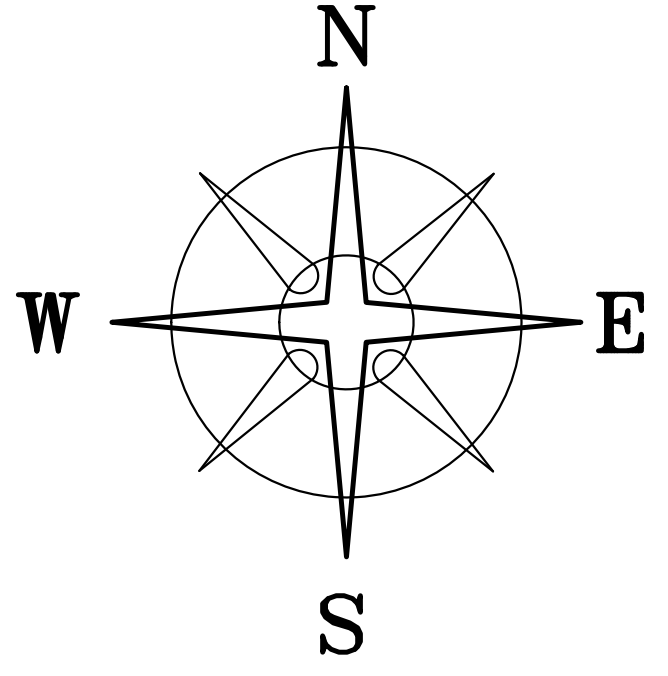

NOTE

0.1390± ACRE TRACT IS TO BECOME PART OF
AND CONTINGENT TO WRIGHT'S 0.67 ACRE TRACT.

MARK E & KATHLEEN ANTHONY
OR 207 P 1535
114.25 ACRES
PARCEL 3

DEED REFERENCE
PATSY ROLFE PARRISH
OR P
① 0.84 ACRES
0.8153± ACRES

(BY NEW SURVEY APRIL OF 2015)(NOT RECORDED TO DATE)
SEE 1994 PLAT OF MIDWAY (SEDALIA)
22-00178.000

MARGARET E WRIGHT
OR 69 P 892
0.67 ACRES
N 632,062.87
E 1,695,424.20

POB

0.1390± ACRES

16.44' ALLEY

V.M.S. 7263
V.M.S. 6050
MIDWAY CORP. LINE

RANGE TOWNSHIP

ADDITION
SLIDE 200
MIDWAY CORP. LINE

RANGE TOWNSHIP

BROAD STREET 66'

STREET

MOUND

(49.82')

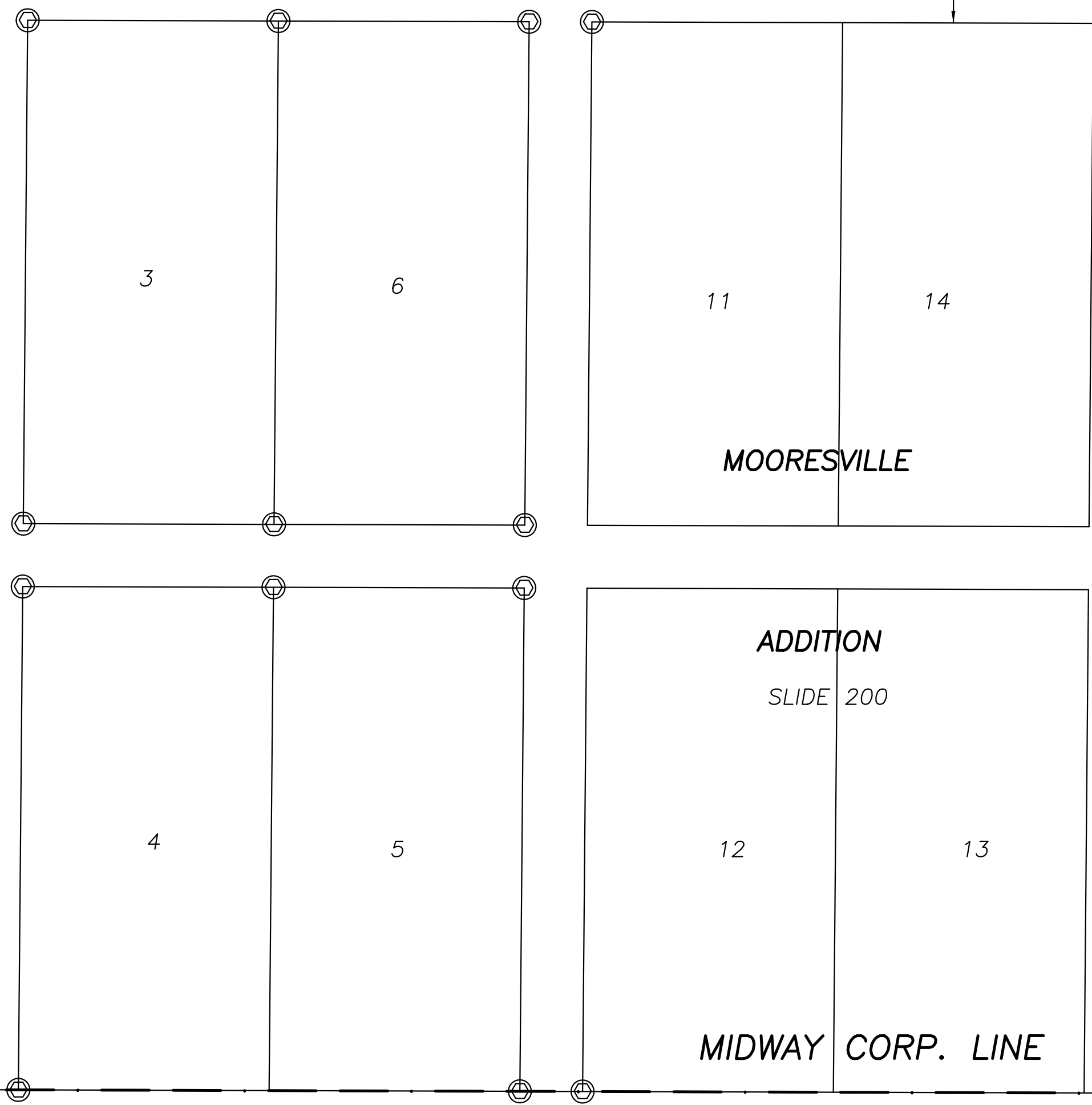

LEGEND

- 5/8" IRON PIN (FOUND)
- ⊙ 5/8" Ø REBAR & YELLOW PLASTIC CAP STAMPED "COTTRILL 6858" (PREVIOUSLY SET)
- ⊙ 5/8" Ø REBAR & YELLOW PLASTIC CAP STAMPED "COTTRILL 6858" (SET)

ALL MONUMENTS FOUND OR SET ARE IN GOOD
CONDITION UNLESS OTHERWISE NOTED.

ROBIN A JAGO
DB 286 P 403
26.716 ACRES



I HEREBY CERTIFY THAT THIS PLAT DEPICTS
AN ACTUAL FIELD SURVEY PERFORMED BY
JAMES R. COTTRILL P.S. #6858
DATE: 7/20/15

COTTRILL SURVEYING, LLC
8256 S.R. 207 N.E. MT. STERLING, OHIO 43143 PH. (740) 869-3811
0.8153± ACRES, VMS 6050 & 7263,
VILLAGE OF MIDWAY (SEDALIA),
MADISON COUNTY, OHIO
SURVEYED FOR MARGARET WRIGHT

DATE DRAWN:
6/30/15
JOB # S150618
F. B. #

SCALE : 1" = 30'
30' 15' 0' 30'

CREW: MATT WOOD
DRAWN BY: MATT WOOD

Cottrill Surveying, LLC

8256 State Route 207 NE, Mt. Sterling, Ohio 43143, Ph. (740)869-3811

0.1390 Acre Tract Surveyed for Margaret Wright

The following describe 0.1390 acre tract is situated in the State of Ohio, Madison County, Village of Midway (Sedalia), VMS 6050 and 7263, and being part of a 0.8153 acre tract (2200178.000) conveyed to Patsy Rolfe Parrish by Official Record _____ page _____, and being more particularly described as follows:

Beginning at a 5/8 inch diameter iron pin found in the centerline of Broad Street (66 feet wide) at the northwest corner of said 0.8153 acre tract and the southwest corner of a 0.67 acre tract conveyed to Margaret E Wright by Official Record 69 page 892;

Thence, with the south line of said 0.67 acre tract, **South 89° 50' 00" East** a distance of **147.32 feet** to an iron pin and cap previously set in the west line of a 114.25 acre tract conveyed to Mark E and Kathleen Anthony by Official Record 207 page 1535;

Thence, with the west line of said 114.25 acre tract, **South 12° 49' 15" West** a distance of **51.00 feet** to an iron pin and cap set;

Thence, with a new line across said 0.8153 acre tract, **North 83° 39' 15" West** a distance of **137.15 feet** to an iron pin and cap set in the east line of a 16.44 foot alley;

Thence, with the east line of said alley, **North 00° 30' 00" East** a distance of **35.00 feet** returning to the point of beginning containing **0.1390 Acres** more or less.

The hereinabove described 0.1390 acre tract is to become part of and contingent to Wright's 0.67 acre tract and is not to stand alone as a building lot.

Bearings are based on the north line of Broad Street (South 89° 50' East) as shown on slide #200 of Mooresville Addition.

This deed is subject to and with the benefit of all legal highways, restrictions, easements, limitations, and reservations, of record, if any and to zoning restrictions which have been imposed thereon, if any.

All iron pins set are 5/8 inch diameter rebar with yellow plastic caps stamped "Cottrill L.L.C. 6858."

This description is based on a field survey performed July 20, 2015 by James R. Cottrill registration #6858. (Job #S150618-0-1390AC)

James R. Cottrill, PS