

JOHN T. MITCHELL
 D.B. 287 PG. 819
 141.6455 ACRES

(118.1184 AC. MADISON CO.)
 (61.6293 AC. SOMERFORD TWN.)
 (56.4892 AC. UNION TWN.)

S 58°15'25"W - 809.83'

5.4194 ACRES

(3,9605 AC.)
 SOMERFORD TOWNSHIP
 UNION TOWNSHIP
 (1,4589 AC.)

MARKLEY ROAD (40'R/W)



MARY JANE CLINE
 D.B. 143 PG. 442
 106.98 AC.

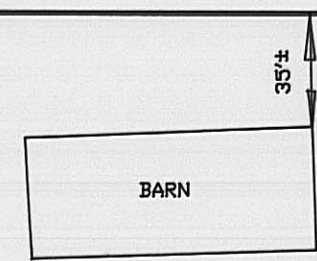

WIRE FENCE

N 39°15'00"W - 272.27'

N 51°01'17"E - 91.92'

85.85'

6.07'

20.00'



BEARINGS BASED ON THE NORTHEASTERN LINE
 OF WITBECK'S 197.03 AC. TRACT (N39°15'W)
 AS DESCRIBED IN D.B. 200 PG. 37.

LEGEND

- 3/8" DIA. SOLID IRON PIN (FOUND)
- 5/8" DIA. REBAR SET OVER 5/8"φ SOLID IRON PIN FOUND 1' DEEP
- 5/8" DIA. REBAR & YELLOW PLASTIC CAP STAMPED "COTTRILL 6858" (SET)

I HEREBY CERTIFY THAT THIS PLAT
 DEPICTS AN ACTUAL FIELD SURVEY
 PERFORMED BY JAMES R. COTTRILL P.S. #6858
James R. Cottrill DATE 3-14-92

JAMES R. COTTRILL P.S.

8256 S.R.207 N.E. MT. STERLING, OHIO 43143 PH. (614) 869-3811

PLAT OF

5.4194 ACRES, VMS 4214, SOMERFORD
 & UNION TOWNSHIPS, MADISON COUNTY,
 STATE OF OHIO.

DATE:
 3-14-92

SCALE: 1" = 60'
 60' 30' 0 60'

41-92