

— Plat of the —
Fitzgerald Road Improvement.
 Fairfield Twp, Mason Co, Ohio.

Scale 200'

Length	1250'
Width	40'
Grade	24'
Gravel	13'

— 1894. —

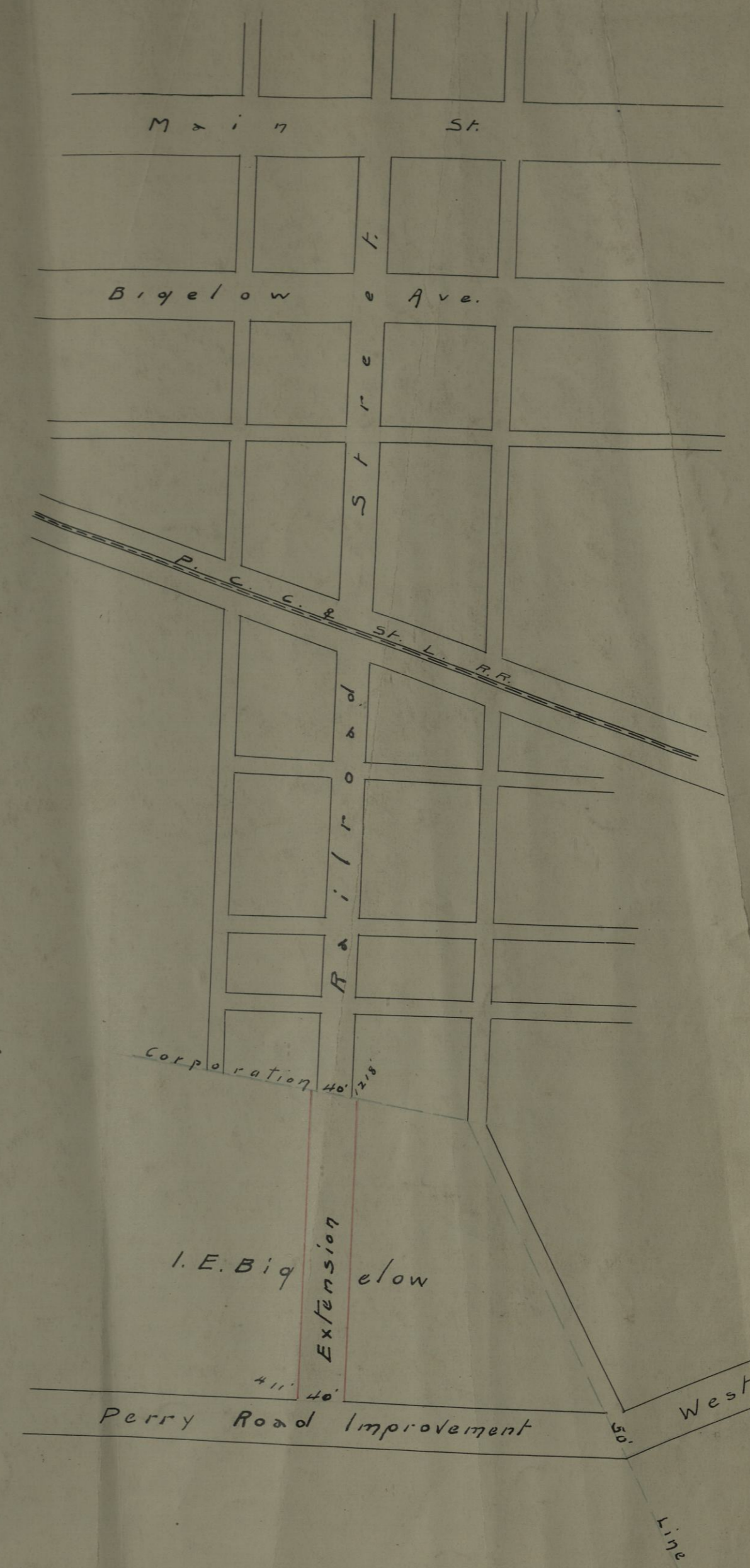

— Plat of —
Railroad Street Extension,
 Plain City, Ohio.
 Scale 150' — 1894.