

CANAAN TWP. ROADS

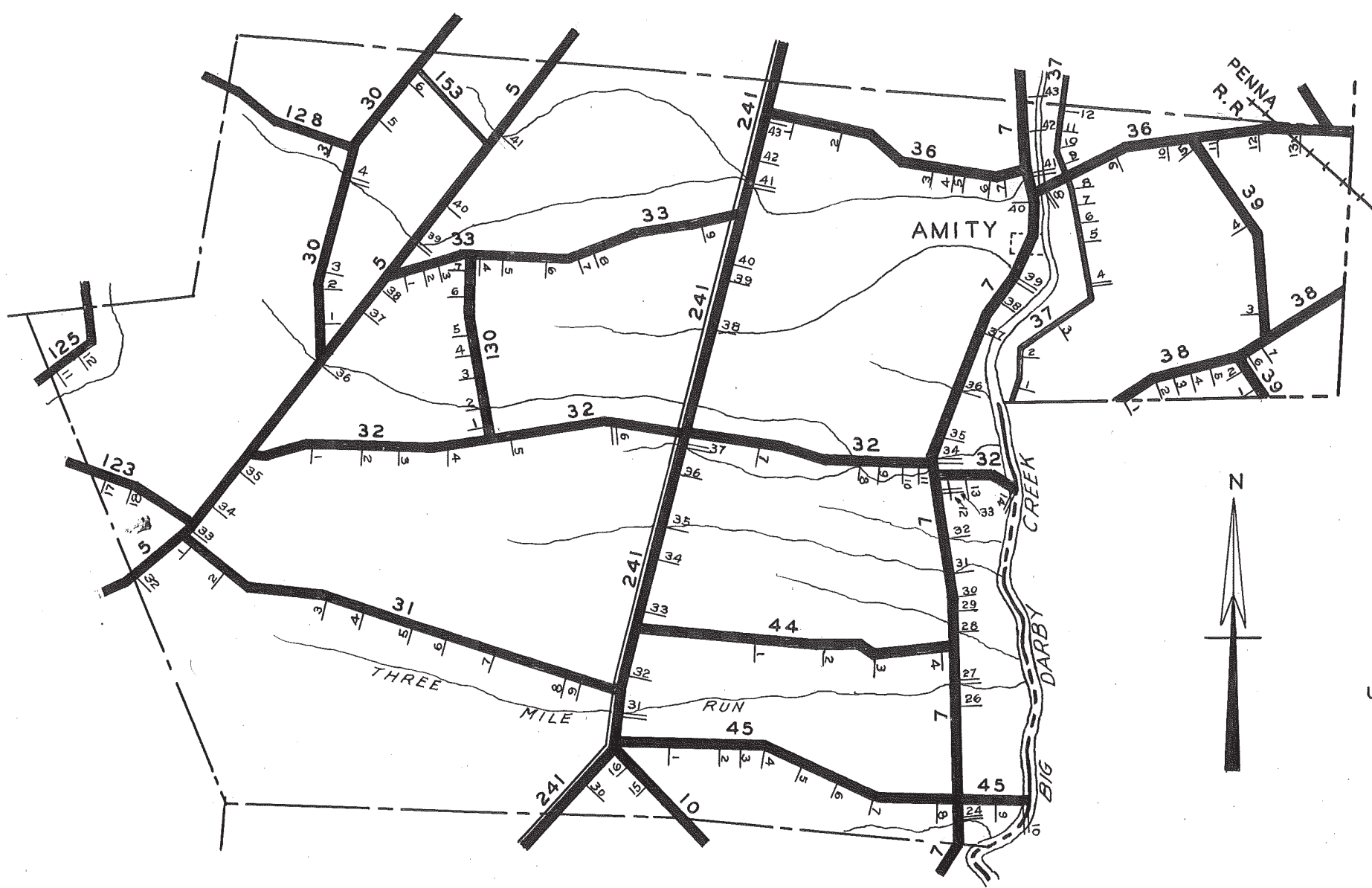

No	NAME	TYPE IN MILES			WIDTH
		S	C	T	
5	LAFAYETTE-PLAIN CITY		4.73		50 FT.
7	PLAIN CITY-GEORGESVILLE		5.78		50 FT.
10	MIDDLE PIKE		0.88		50 FT.
30-A	AMISH		2.29		45 FT.
31	A. W. WILLSON		3.30		50 FT.
32	PRICE-HILLIARDS		5.47		SEE NOTE
33	KILLBURY-HUBER		2.41		
35	IAMS		0.02		50 FT.
36	AMITY PIKE		4.29		SEE NOTE
37	SMITH & CALHOUN			2.23	
38	HAYDEN RUN		1.74		45 FT.
39	CARTERS MILL		1.71		SEE NOTE
44	M.V. HIGH		2.23		40 FT.
45	LUCAS		3.00		60 FT.
123	FINLEY-GUY		0.86		50 FT.
125	WOODS & WEST AVE		0.56		50 FT.
128	GUY AVE		0.88		50 FT.
130	KILBURY		1.29		45 FT.
153	KAUFMAN			0.87	40 FT.
241	LONDON-DELAWARE	5.20			60 FT.

U.S.42

TOTAL MILES:

STATE	5.20
COUNTY	41.44
TOWNSHIP	3.10

LEGEND:

- STATE & FEDERAL HIGHWAY
- COUNTY HIGHWAY-HARD SURFACE
- COUNTY HIGHWAY-GRAVEL
- TOWNSHIP HIGHWAY-HARD SURFACE
- TOWNSHIP HIGHWAY-GRAVEL
- CULVERT
- BRIDGE

NOTE:

- ROAD No
- 32 - 45 FT. WIDE FROM BIG DARBY CREEK TO ROAD No 7 - BALANCE 50 FT. WIDE
 - 36 - 40 FT. WIDE WEST OF AMITY
50 FT. WIDE EAST OF AMITY
 - 39 - 45 FT. WIDE NORTH OF ROAD No 38

ROAD MAP
SHOWING BRIDGES AND CULVERTS
CANAAN TOWNSHIP
MADISON COUNTY
OFFICE OF COUNTY ENGINEER
LONDON OHIO
1964

