

# TRAFFIC CRASH REPORT

\*DENOTES MANDATORY FIELD FOR SUPPLEMENT REPORT

LOCAL REPORT NUMBER \*

49-0553-49

<input checked="" type="checkbox"/> PHOTOS TAKEN <input type="checkbox"/> SECONDARY CRASH		<input checked="" type="checkbox"/> OH -2 <input type="checkbox"/> OH-1P <input type="checkbox"/> PRIVATE PROPERTY		LOCAL INFORMATION P21121100000309 REPORTING AGENCY NAME * Ohio State Highway Patrol		NCIC * OHP49		HIT/SKIP 1 - SOLVED 2 - UNSOLVED		NUMBER OF UNITS 1		UNIT IN ERROR 98 - ANIMAL 99 - UNKNOWN	
COUNTY* 49		LOCALITY* 1 - CITY 2 - VILLAGE 3 - TOWNSHIP 3		LOCATION: CITY, VILLAGE, TOWNSHIP* Fairfield (Township of)		CRASH DATE / TIME* 12/11/2021 03:09		CRASH SEVERITY 1 - FATAL 2 - SERIOUS INJURY SUSPECTED 3 - MINOR INJURY SUSPECTED 4 - INJURY POSSIBLE 5 - PROPERTY DAMAGE ONLY 2					
ROUTE TYPE LOCATION		ROUTE NUMBER LOCATION		PREFIX 1 - NORTH 2 - SOUTH 3 - EAST 4 - WEST		LOCATION ROAD NAME Lilly Chapel Opossum Run		ROAD TYPE RD		LATITUDE DECIMAL DEGREES 39.870092		LONGITUDE DECIMAL DEGREES -83.267896	
ROUTE TYPE REFERENCE		ROUTE NUMBER REFERENCE		PREFIX 1 - NORTH 2 - SOUTH 3 - EAST 4 - WEST		REFERENCE ROAD NAME (ROAD, MILEPOST, HOUSE #) 4765		ROAD TYPE RD					
REFERENCE POINT 1 - INTERSECTION 2 - MILE POST 3 - HOUSE # 3		DIRECTION FROM REFERENCE 1 - NORTH 2 - SOUTH 3 - EAST 4 - WEST		ROUTE TYPE IR - INTERSTATE ROUTE (TP) US - FEDERAL US ROUTE SR - STATE ROUTE CR - NUMBERED COUNTY ROUTE TR - NUMBERED TOWNSHIP ROUTE		ROAD TYPE AL - ALLEY AV - AVENUE BL - BOULEVARD CR - CIRCLE CT - COURT DR - DRIVE HE - HEIGHTS		HW - HIGHWAY LA - LANE MP - MILEPOST OV - OVAL PK - PARKWAY PI - PIKE PL - PLACE		RD - ROAD SQ - SQUARE ST - STREET TE - TERRACE TL - TRAIL WA - WAY		INTERSECTION RELATED <input type="checkbox"/> WITHIN INTERSECTION OR ON APPROACH <input type="checkbox"/> WITHIN INTERCHANGE AREA NUMBER OF APPROACHES	
DISTANCE FROM REFERENCE LOCATION		DISTANCE UNIT OF MEASURE 1 - MILES 2 - FEET 3 - YARDS		ROUTE TYPE CR - NUMBERED COUNTY ROUTE TR - NUMBERED TOWNSHIP ROUTE		ROAD TYPE AL - ALLEY AV - AVENUE BL - BOULEVARD CR - CIRCLE CT - COURT DR - DRIVE HE - HEIGHTS		HW - HIGHWAY LA - LANE MP - MILEPOST OV - OVAL PK - PARKWAY PI - PIKE PL - PLACE		RD - ROAD SQ - SQUARE ST - STREET TE - TERRACE TL - TRAIL WA - WAY		ROADWAY <input type="checkbox"/> ROADWAY DIVIDED	
LOCATION OF FIRST HARMFUL EVENT 1 - ON ROADWAY 2 - ON SHOULDER 3 - IN MEDIAN 4 - ON ROADSIDE 5 - ON GORE 6 - OUTSIDE TRAFFIC WAY 7 - ON RAMP 8 - OFF RAMP 4				MANNER OF CRASH COLLISION/IMPACT 1 - NOT COLLISION BETWEEN TWO MOTOR VEHICLES IN TRANSPORT 2 - REAR-END 3 - HEAD-ON 4 - REAR-TO-REAR 5 - BACKING 6 - ANGLE 7 - SIDESWIPE, SAME DIRECTION 8 - SIDESWIPE, OPPOSITE DIRECTION 9 - OTHER / UNKNOWN 1				DIRECTION OF TRAVEL 1 - NORTH 2 - SOUTH 3 - EAST 4 - WEST		MEDIAN TYPE 1 - DIVIDED FLUSH MEDIAN (< 4 FEET) 2 - DIVIDED FLUSH MEDIAN (≥ 4 FEET) 3 - DIVIDED, DEPRESSED MEDIAN 4 - DIVIDED, RAISED MEDIAN (ANY TYPE) 9 - OTHER / UNKNOWN			
<input type="checkbox"/> WORK ZONE RELATED <input type="checkbox"/> WORKERS PRESENT <input type="checkbox"/> LAW ENFORCEMENT PRESENT <input type="checkbox"/> ACTIVE SCHOOL ZONE		WORK ZONE TYPE 1 - LANE CLOSURE 2 - LANE SHIFT/ CROSSOVER 3 - WORK ON SHOULDER OR MEDIAN 4 - INTERMITTENT OR MOVING WORK 5 - OTHER		LOCATION OF CRASH IN WORK ZONE 1 - BEFORE THE 1ST WORK ZONE WARNING SIGN 2 - ADVANCE WARNING AREA 3 - TRANSITION AREA 4 - ACTIVITY AREA 5 - TERMINATION AREA		CONTOUR 1 1 - STRAIGHT LEVEL 2 - STRAIGHT GRADE 3 - CURVE LEVEL 4 - CURVE GRADE 9 - OTHER /UNKNOWN		CONDITIONS 2 1 - DRY 2 - WET 3 - SNOW 4 - ICE 5 - SAND, MUD, DIRT, OIL, GRAVEL 6 - WATER (STANDING, MOVING) 7 - SLUSH 9 - OTHER / UNKNOWN		SURFACE 2 1 - CONCRETE 2 - BLACKTOP, BITUMINOUS, ASPHALT 3 - BRICK/BLOCK 4 - SLAG, GRAVEL, STONE 5 - DIRT 9 - OTHER / UNKNOWN			
LIGHT CONDITION 1 - DAYLIGHT 2 - DAWN/DUSK 3 - DARK - LIGHTED ROADWAY 4 - DARK - ROADWAY NOT LIGHTED 5 - DARK - UNKNOWN ROADWAY LIGHTING 9 - OTHER / UNKNOWN 4				WEATHER 1 - CLEAR 2 - CLOUDY 3 - FOG, SMOG, SMOKE 4 - RAIN 5 - SLEET, HAIL 6 - SNOW 7 - SEVERE CROSSWINDS 8 - BLOWING SAND, SOIL, DIRT, SNOW 9 - FREEZING RAIN OR FREEZING DRIZZLE 99 - OTHER / UNKNOWN 4				CRASH REPORTED DATE / TIME 12/11/2021 03:09					
DISPATCH DATE / TIME 12/11/2021 03:09				ARRIVAL DATE / TIME 12/11/2021 03:31				SCENE CLEARED DATE / TIME 12/11/2021 04:43					
REPORT TAKEN BY <input checked="" type="checkbox"/> POLICE AGENCY <input type="checkbox"/> MOTORIST				TOTAL TIME ROADWAY CLOSED 93				OTHER INVESTIGATION TIME 45					
TOTAL MINUTES 139				OFFICER'S NAME* Bailey, Ryan				CHECKED BY OFFICER'S NAME* Snodgrass, Jason					
OFFICER'S BADGE NUMBER* 1815				CHECKED BY OFFICER'S BADGE NUMBER* 1666				<input checked="" type="checkbox"/> SUPPLEMENT (CORRECTION OR ADDITION TO AN EXISTING REPORT SENT TO ODPS)					

NARRATIVE  
 Unit #1 was driving to the northwest on Lilly Chapel Opossum Run Road. Unit #1 drove off the right side of the roadway striking a tree. Supplemented 12/19/2021: Entered field measurements for OH2 and updated OH2 Diagram.

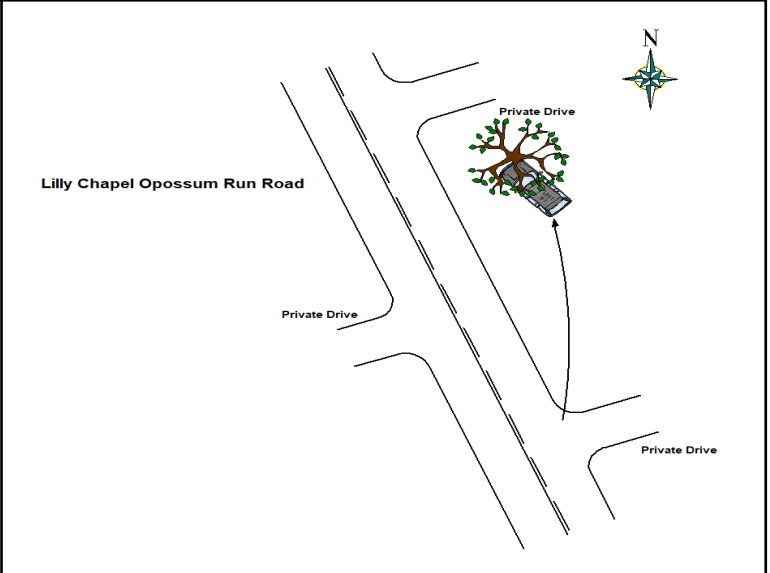

<b>UNIT #</b> 1	<b>OWNER NAME:</b> LAST, FIRST, MIDDLE (☐ SAME AS DRIVER) KEATON, BROOKLYN, ELIZABETH	<b>OWNER PHONE:</b> INCLUDE AREA CODE (☐ SAME AS DRIVER)
<b>OWNER ADDRESS:</b> STREET, CITY, STATE, ZIP (☐ SAME AS DRIVER) 8795 THOMAS LN, WEST JEFFERSON, OH, 43162		
<b>COMMERCIAL CARRIER:</b> NAME, ADDRESS, CITY, STATE, ZIP		<b>COMMERCIAL CARRIER PHONE:</b> INCLUDE AREA CODE

<b>LP STATE</b> OH	<b>LICENSE PLATE #</b> JNE3489	<b>VEHICLE IDENTIFICATION #</b> 5N1AT2MV3KC755573	<b>VEHICLE YEAR</b> 2019	<b>VEHICLE MAKE</b> NISSAN
<input checked="" type="checkbox"/> <b>INSURANCE VERIFIED</b>	<b>INSURANCE COMPANY</b> PROGRESSIVE	<b>INSURANCE POLICY #</b> 911744713	<b>COLOR</b> BLK	<b>VEHICLE MODEL</b> ROGUE
<b>TYPE OF USE</b> <input type="checkbox"/> COMMERCIAL <input type="checkbox"/> GOVERNMENT <input type="checkbox"/> IN EMERGENCY RESPONSE		<b>US DOT #</b>	<b>TOWED BY:</b> COMPANY NAME FLYNN TOWING	
<input type="checkbox"/> <b>INTERLOCK DEVICE EQUIPPED</b>	<input type="checkbox"/> <b>HIT/SKIP UNIT</b>	<b>VEHICLE WEIGHT GVWR/GCWR</b> 1 - ≤10K LBS. 2 - 10.001 - 26K LBS. 3 - > 26K LBS.	<b>HAZARDOUS MATERIAL</b> <input type="checkbox"/> MATERIAL CLASS # <input type="checkbox"/> RELEASED <input type="checkbox"/> PLACARD PLACARD ID #	

<b>UNIT TYPE</b> 3	1 - PASSENGER CAR 2 - PASSENGER VAN (MINIVAN) 3 - SPORT UTILITY VEHICLE 4 - PICK UP 5 - CARGO VAN	6 - VAN (9-15 SEATS) 7 - MOTORCYCLE 2-WHEELED 8 - MOTORCYCLE 3-WHEELED 9 - AUTOCYCLE 10 - MOPED OR MOTORIZED BICYCLE 11 - ALL TERRAIN VEHICLE (ATV/UTV)	12 - GOLF CART 13 - SNOWMOBILE 14 - SINGLE UNIT TRUCK 15 - SEMI-TRACTOR 16 - FARM EQUIPMENT 17 - MOTORHOME	18 - LIMO (LIVERY VEHICLE) 19 - BUS (16+ PASSENGERS) 20 - OTHER VEHICLE 21 - HEAVY EQUIPMENT 22 - ANIMAL WITH RIDER OR ANIMAL-DRAWN VEHICLE	23 - PEDESTRIAN/SKATER 24 - WHEELCHAIR (ANY TYPE) 25 - OTHER NON-MOTORIST 26 - BICYCLE 27 - TRAIN 99 - UNKNOWN OR HIT/SKIP
<b># of TRAILING UNITS</b> 0	<b>WAS VEHICLE OPERATING IN AUTONOMOUS MODE WHEN CRASH OCCURRED?</b> 0 - NO AUTOMATION 1 - DRIVER ASSISTANCE 2 - PARTIAL AUTOMATION 3 - CONDITIONAL AUTOMATION 4 - HIGH AUTOMATION 5 - FULL AUTOMATION 9 - OTHER/UNKNOWN				

<b>SPECIAL FUNCTION</b> 1	1 - NONE 2 - TAXI 3 - ELECTRONIC RIDE SHARING 4 - SCHOOL TRANSPORT 5 - BUS - TRANSIT/COMMUTER	6 - BUS - CHARTER/TOUR 7 - BUS - INTERCITY 8 - BUS - SHUTTLE 9 - BUS - OTHER 10 - AMBULANCE	11 - FIRE 12 - MILITARY 13 - POLICE 14 - PUBLIC UTILITY 15 - CONSTRUCTION EQUIP.	16 - FARM 17 - MOWING 18 - SNOW REMOVAL 19 - TOWING 20 - SAFETY SERVICE PATROL	21 - MAIL CARRIER 99 - OTHER / UNKNOWN
<b>CARGO BODY TYPE</b> 1	1 - NO CARGO BODY TYPE / NOT APPLICABLE 2 - BUS 3 - VEHICLE TOWING ANOTHER MOTOR VEHICLE	4 - LOGGING 5 - INTERMODAL CONTAINER CHASSIS 6 - CARGOVAN /ENCLOSED BOX	7 - GRAIN/CHIPS/GRAVEL 8 - POLE 9 - CARGO TANK 10 - FLAT BED	11 - DUMP 12 - CONCRETE MIXER 13 - AUTO TRANSPORTER 14 - GARBAGE/REFUSE	99 - OTHER / UNKNOWN

<b>VEHICLE DEFECTS</b>	1 - TURN SIGNALS 2 - HEAD LAMPS 3 - TAIL LAMPS	4 - BRAKES 5 - STEERING 6 - TIRE BLOWOUT	7 - WORN OR SLICK TIRES 8 - TRAILER EQUIPMENT DEFECTIVE	9 - MOTOR TROUBLE 10 - DISABLED FROM PRIOR ACCIDENT	99 - OTHER / UNKNOWN
<b>NON-MOTORIST LOCATION AT IMPACT</b>	1 - INTERSECTION - MARKED CROSSWALK 2 - INTERSECTION - UNMARKED CROSSWALK 3 - INTERSECTION - OTHER	4 - MIDBLOCK - MARKED CROSSWALK 5 - TRAVEL LANE - OTHER LOCATION 6 - BICYCLE LANE	7 - SHOULDER/ROADSIDE 8 - SIDEWALK 9 - MEDIAN/CROSSING ISLAND	10 - DRIVEWAY ACCESS 11 - SHARED USE PATHS OR TRAILS 12 - FIRST RESPONDER AT INCIDENT SCENE	99 - OTHER / UNKNOWN

<b>ACTION</b> 3	1 - NON-CONTACT 2 - NON-COLLISION 3 - STRIKING 4 - STRUCK 5 - BOTH STRIKING & STRUCK 9 - OTHER / UNKNOWN	1 - STRAIGHT AHEAD 2 - BACKING 3 - CHANGING LANES 4 - OVERTAKING/PASSING 5 - MAKING RIGHT TURN 6 - MAKING LEFT TURN 7 - MAKING U-TURN 8 - ENTERING TRAFFIC LANE	9 - LEAVING TRAFFIC LANE 10 - PARKED 11 - SLOWING OR STOPPED IN TRAFFIC 12 - DRIVERLESS 13 - NEGOTIATING A CURVE 14 - ENTERING OR CROSSING SPECIFIED LOCATION	15 - WALKING, RUNNING, JOGGING, PLAYING 16 - WORKING 17 - PUSHING VEHICLE 18 - APPROACHING OR LEAVING VEHICLE 19 - STANDING 20 - OTHER NON-MOTORIST	21 - STANDING OUTSIDE DISABLED VEHICLE 99 - OTHER / UNKNOWN
<b>CONTRIBUTING CIRCUMSTANCES</b> 11	1 - NONE 2 - FAILURE TO YIELD 3 - RAN RED LIGHT 4 - RAN STOP SIGN 5 - UNSAFE SPEED 6 - IMPROPER TURN 7 - LEFT OF CENTER	8 - FOLLOWING TOO CLOSE /ACDA 9 - IMPROPER LANE CHANGE 10 - IMPROPER PASSING 11 - DROVE OFF ROAD 12 - IMPROPER BACKING	13 - IMPROPER START FROM A PARKED POSITION 14 - STOPPED OR PARKED ILLEGALLY 15 - SWERVING TO AVOID 16 - WRONG WAY 17 - VISION OBSTRUCTION	18 - OPERATING DEFECTIVE EQUIPMENT 19 - LOAD SHIFTING /FALLING/SPILLING 20 - IMPROPER CROSSING 21 - LYING IN ROADWAY 22 - NOT DISCERNIBLE	23 - OPENING DOOR INTO ROADWAY 99 - OTHER IMPROPER ACTION

<b>SEQUENCE OF EVENTS</b>	1 - OVERTURN/ROLLOVER 2 - FIRE/EXPLOSION 3 - IMMERSION 4 - JACKKNIFE 5 - CARGO / EQUIPMENT LOSS OR SHIFT 6 - EQUIPMENT FAILURE	7 - SEPARATION OF UNITS 8 - RAN OFF ROAD RIGHT 9 - RAN OFF ROAD LEFT 10 - CROSS MEDIAN 11 - CROSS CENTERLINE - OPPOSITE DIRECTION OF TRAVEL	<b>EVENTS</b> 12 - DOWNHILL RUNAWAY 13 - OTHER NON-COLLISION 14 - PEDESTRIAN 15 - PEDALCYCLE 16 - RAILWAY VEHICLE 17 - ANIMAL - FARM 18 - ANIMAL - DEER	19 - ANIMAL - OTHER 20 - MOTOR VEHICLE IN TRANSPORT 21 - PARKED MOTOR VEHICLE 22 - WORK ZONE MAINTENANCE EQUIPMENT	23 - STRUCK BY FALLING, SHIFTING CARGO OR ANYTHING SET IN MOTION BY A MOTOR VEHICLE 24 - OTHER MOVABLE OBJECT
---------------------------	---	---	--	---	--

<b>FIRST HARMFUL EVENT</b> 2	25 - IMPACT ATTENUATOR / CRASH CUSHION 26 - BRIDGE OVERHEAD STRUCTURE 27 - BRIDGE PIER OR ABUTMENT 28 - BRIDGE PARAPET 29 - BRIDGE RAIL 30 - GUARDRAIL FACE	31 - GUARDRAIL END 32 - PORTABLE BARRIER 33 - MEDIAN CABLE BARRIER 34 - MEDIAN GUARDRAIL BARRIER 35 - MEDIAN CONCRETE BARRIER 36 - MEDIAN OTHER BARRIER 37 - TRAFFIC SIGN POST	38 - OVERHEAD SIGN POST 39 - LIGHT / LUMINARIES SUPPORT 40 - UTILITY POLE 41 - OTHER POST, POLE OR SUPPORT 42 - CULVERT 43 - CURB 44 - DITCH	45 - EMBANKMENT 46 - FENCE 47 - MAILBOX 48 - TREE 49 - FIRE HYDRANT 50 - WORK ZONE MAINTENANCE EQUIPMENT 51 - WALL	52 - BUILDING 53 - TUNNEL 54 - OTHER FIXED OBJECT 99 - OTHER / UNKNOWN
<b>MOST HARMFUL EVENT</b> 2	<b>COLLISION WITH FIXED OBJECT - STRUCK</b>				

LOCAL REPORT NUMBER

49-0553-49

**DAMAGE**

**DAMAGE SCALE**

1 - NONE  
2 - MINOR DAMAGE  
3 - FUNCTIONAL DAMAGE  
4 - DISABLING DAMAGE  
9 - UNKNOWN

4

**DAMAGED AREA(S)**

INDICATE ALL THAT APPLY

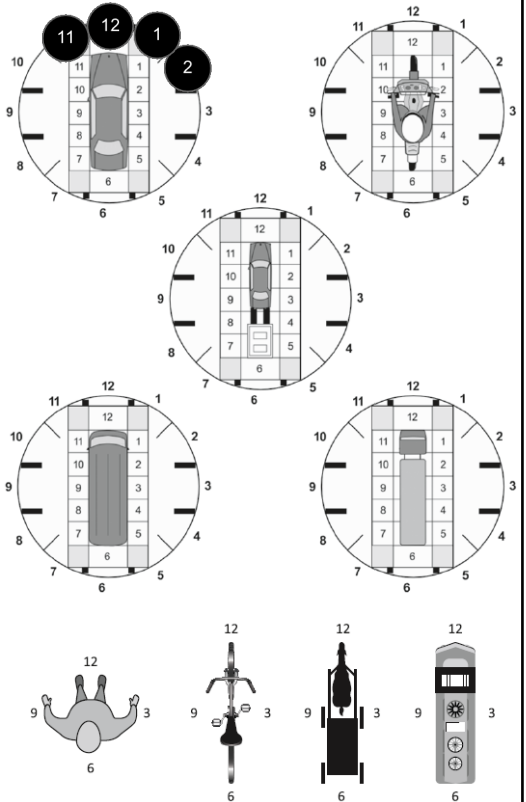

NO DAMAGE [ 0 ]  UNDERCARRIAGE [ 14 ]

TOP [ 13 ]  ALL AREAS [ 15 ]

UNIT NOT AT SCENE [ 16 ]

**INITIAL POINT OF CONTACT**

0 - NO DAMAGE  
1 - 1-12 - REFER TO UNIT DIAGRAM  
13 - TOP  
14 - UNDERCARRIAGE  
15 - VEHICLE NOT AT SCENE  
99 - UNKNOWN

1

**TRAFFIC**

<b>TRAFFICWAY FLOW</b> 1 - ONE-WAY 2 - TWO-WAY	<b>TRAFFIC CONTROL</b> 1 - ROUNDABOUT 2 - SIGNAL 3 - FLASHER 4 - STOP SIGN 5 - YIELD SIGN 6 - NO CONTROL
--	--

<b># OF THROUGH LANES ON ROAD</b> 2	<b>RAIL GRADE CROSSING</b> 1 - NOT INVOLVED 2 - INVOLVED-ACTIVE CROSSING 3 - INVOLVED-PASSIVE CROSSING
--	---

**UNIT / NON-MOTORIST DIRECTION**

FROM 7 TO 6

1 - NORTH  
2 - SOUTH  
3 - EAST  
4 - WEST  
5 - NORTHEAST  
6 - NORTHWEST  
7 - SOUTHEAST  
8 - SOUTHWEST  
9 - OTHER / UNKNOWN

**UNIT SPEED**

[ ]

**DETECTED SPEED**

1 - STATED / ESTIMATED SPEED  
2 - CALCULATED / EDR  
3 - UNDETERMINED

3

**POSTED SPEED**

55

# MOTORIST / Non-MOTORIST

LOCAL REPORT NUMBER  
49-0553-49

<b>UNIT #</b> 1	<b>NAME: LAST, FIRST, MIDDLE</b> SCOTT, DARREN, BANE					<b>DATE OF BIRTH</b> 10/27/1998		<b>AGE</b> 23	<b>GENDER</b> M	
<b>ADDRESS: STREET, CITY, STATE, ZIP</b> 4275 LILLY CHAPEL OPOSSUM RUN RD, LONDON, OH, 43140					<b>CONTACT PHONE - INCLUDE AREA CODE</b>					
<b>INJURIES</b> 2	<b>INJURED TAKEN BY</b> 2	<b>EMS AGENCY (NAME)</b> Fairfield Township	<b>INJURED TAKEN TO: MEDICAL FACILITY (NAME, CITY)</b> Grant Medical Center		<b>SAFETY EQUIPMENT USED</b> 1	<input type="checkbox"/> DOT-COMPLIANT <input checked="" type="checkbox"/> MC HELMET	<b>SEATING POSITION</b> 1	<b>AIR BAG USAGE</b> 4	<b>EJECTION</b> 1	<b>TRAPPED</b> 1
<b>OL STATE</b> OH	<b>OPERATOR LICENSE NUMBER</b>		<b>OFFENSE CHARGED</b>		<b>LOCAL CODE</b> <input type="checkbox"/>	<b>OFFENSE DESCRIPTION</b>			<b>CITATION NUMBER</b>	
<b>OL CLASS</b> 4	<b>ENDORSEMENT</b>	<b>RESTRICTION</b> SELECT UP TO 3 3	<b>DRIVER DISTRACTED BY</b> 1	<b>ALCOHOL / DRUG SUSPECTED</b> <input checked="" type="checkbox"/> ALCOHOL <input type="checkbox"/> MARIJUANA <input type="checkbox"/> OTHER DRUG		<b>CONDITION</b> 6	<b>ALCOHOL TEST</b>		<b>DRUG TEST(S)</b>	
						STATUS		TYPE		RESULTS SELECT UP TO 4
						1		1		

<b>UNIT #</b>	<b>NAME: LAST, FIRST, MIDDLE</b>					<b>DATE OF BIRTH</b>		<b>AGE</b>	<b>GENDER</b>	
<b>ADDRESS: STREET, CITY, STATE, ZIP</b>					<b>CONTACT PHONE - INCLUDE AREA CODE</b>					
<b>INJURIES</b>	<b>INJURED TAKEN BY</b>	<b>EMS AGENCY (NAME)</b>	<b>INJURED TAKEN TO: MEDICAL FACILITY (NAME, CITY)</b>		<b>SAFETY EQUIPMENT USED</b>	<input type="checkbox"/> DOT-COMPLIANT <input type="checkbox"/> MC HELMET	<b>SEATING POSITION</b>	<b>AIR BAG USAGE</b>	<b>EJECTION</b>	<b>TRAPPED</b>
<b>OL STATE</b>	<b>OPERATOR LICENSE NUMBER</b>		<b>OFFENSE CHARGED</b>		<b>LOCAL CODE</b> <input type="checkbox"/>	<b>OFFENSE DESCRIPTION</b>			<b>CITATION NUMBER</b>	
<b>OL CLASS</b>	<b>ENDORSEMENT</b>	<b>RESTRICTION</b> SELECT UP TO 3	<b>DRIVER DISTRACTED BY</b>	<b>ALCOHOL / DRUG SUSPECTED</b> <input type="checkbox"/> ALCOHOL <input type="checkbox"/> MARIJUANA <input type="checkbox"/> OTHER DRUG		<b>CONDITION</b>	<b>ALCOHOL TEST</b>		<b>DRUG TEST(S)</b>	
						STATUS		TYPE		RESULTS SELECT UP TO 4

<b>UNIT #</b>	<b>NAME: LAST, FIRST, MIDDLE</b>					<b>DATE OF BIRTH</b>		<b>AGE</b>	<b>GENDER</b>	
<b>ADDRESS: STREET, CITY, STATE, ZIP</b>					<b>CONTACT PHONE - INCLUDE AREA CODE</b>					
<b>INJURIES</b>	<b>INJURED TAKEN BY</b>	<b>EMS AGENCY (NAME)</b>	<b>INJURED TAKEN TO: MEDICAL FACILITY (NAME, CITY)</b>		<b>SAFETY EQUIPMENT USED</b>	<input type="checkbox"/> DOT-COMPLIANT <input type="checkbox"/> MC HELMET	<b>SEATING POSITION</b>	<b>AIR BAG USAGE</b>	<b>EJECTION</b>	<b>TRAPPED</b>
<b>OL STATE</b>	<b>OPERATOR LICENSE NUMBER</b>		<b>OFFENSE CHARGED</b>		<b>LOCAL CODE</b> <input type="checkbox"/>	<b>OFFENSE DESCRIPTION</b>			<b>CITATION NUMBER</b>	
<b>OL CLASS</b>	<b>ENDORSEMENT</b>	<b>RESTRICTION</b> SELECT UP TO 3	<b>DRIVER DISTRACTED BY</b>	<b>ALCOHOL / DRUG SUSPECTED</b> <input type="checkbox"/> ALCOHOL <input type="checkbox"/> MARIJUANA <input type="checkbox"/> OTHER DRUG		<b>CONDITION</b>	<b>ALCOHOL TEST</b>		<b>DRUG TEST(S)</b>	
						STATUS		TYPE		RESULTS SELECT UP TO 4

INJURIES	SEATING POSITION	AIR BAG	OL CLASS	OL RESTRICTION(S)	DRIVER DISTRACTION	TEST STATUS
1 - FATAL	1 - FRONT - LEFT SIDE (MOTORCYCLE DRIVER)	1 - NOT DEPLOYED	1 - CLASS A	1 - ALCOHOL INTERLOCK DEVICE	1 - NOT DISTRACTED	1 - NONE GIVEN
2 - SUSPECTED SERIOUS INJURY	2 - FRONT - MIDDLE	2 - DEPLOYED FRONT	2 - CLASS B	2 - CDL INTRASTATE ONLY	2 - MANUALLY OPERATING AN ELECTRONIC COMMUNICATION DEVICE (TEXTING, TYPING, VOICING)	2 - TEST REFUSED
3 - SUSPECTED MINOR INJURY	3 - FRONT - RIGHT SIDE	3 - DEPLOYED SIDE	3 - CLASS C	3 - CORRECTIVE LENSES	3 - TALKING ON HANDS-FREE COMMUNICATION DEVICE	3 - TEST GIVEN, CONTAMINATED SAMPLE / UNUSABLE
4 - POSSIBLE INJURY	4 - SECOND - LEFT SIDE (MOTORCYCLE PASSENGER)	4 - DEPLOYED BOTH FRONT/SIDE	4 - REGULAR CLASS (OHIO = D)	4 - FARM WAIVER	4 - TALKING ON HAND-HELD COMMUNICATION DEVICE	4 - TEST GIVEN, RESULTS KNOWN
5 - NO APPARENT INJURY	5 - SECOND - MIDDLE	5 - NOT APPLICABLE	5 - M/C MOPED ONLY	5 - EXCEPT CLASS A BUS	5 - OTHER ACTIVITY WITH AN ELECTRONIC DEVICE	5 - TEST GIVEN, RESULTS UNKNOWN
	6 - SECOND - RIGHT SIDE	9 - DEPLOYMENT UNKNOWN	6 - NO VALID OL	6 - EXCEPT CLASS A & CLASS B BUS	6 - PASSENGER	
	7 - THIRD - LEFT SIDE (MOTORCYCLE SIDE CAR)			7 - EXCEPT TRACTOR-TRAILER	7 - OTHER DISTRACTION INSIDE THE VEHICLE	
	8 - THIRD - MIDDLE	<b>EJECTION</b>		8 - INTERMEDIATE LICENSE RESTRICTIONS	8 - OTHER DISTRACTION OUTSIDE THE VEHICLE	<b>ALCOHOL TEST TYPE</b>
<b>INJURIES TAKEN BY</b>	9 - THIRD - RIGHT SIDE	1 - NOT EJECTED	<b>OL ENDORSEMENT</b>	9 - LEARNER'S PERMIT RESTRICTIONS	9 - OTHER / UNKNOWN	1 - NONE
1 - NOT TRANSPORTED / TREATED AT SCENE	10 - SLEEPER SECTION OF TRUCK CAB	2 - PARTIALLY EJECTED	H - HAZMAT	10 - LIMITED TO DAYLIGHT ONLY		2 - BLOOD
2 - EMS	11 - PASSENGER IN OTHER ENCLOSED CARGO AREA (NON-TRAILING UNIT, BUS, PICK-UP WITH CAP)	3 - TOTALLY EJECTED	M - MOTORCYCLE	11 - LIMITED TO EMPLOYMENT		3 - URINE
3 - POLICE	12 - PASSENGER IN UNENCLOSED CARGO AREA	4 - NOT APPLICABLE	P - PASSENGER	12 - LIMITED - OTHER		4 - BREATH
9 - OTHER / UNKNOWN	13 - TRAILING UNIT	<b>TRAPPED</b>	N - TANKER	13 - MECHANICAL DEVICES (SPECIAL BRAKES, HAND CONTROLS, OR OTHER ADAPTIVE DEVICES)	<b>CONDITION</b>	5 - OTHER
<b>SAFETY EQUIPMENT</b>	14 - RIDING ON VEHICLE EXTERIOR	1 - NOT TRAPPED	Q - MOTOR SCOOTER	14 - MILITARY VEHICLES ONLY	1 - APPARENTLY NORMAL	<b>DRUG TEST TYPE</b>
1 - NONE USED	15 - NON-MOTORIST	2 - EXTRICATED BY MECHANICAL MEANS	R - THREE-WHEEL MOTORCYCLE	15 - MOTOR VEHICLES WITHOUT AIR BRAKES	2 - PHYSICAL IMPAIRMENT	1 - NONE
2 - SHOULDER BELT ONLY USED	99 - OTHER / UNKNOWN	3 - FREED BY NON-MECHANICAL MEANS	S - SCHOOL BUS	16 - OUTSIDE MIRROR	3 - EMOTIONAL (E.G., DEPRESSED, ANGRY, DISTURBED)	2 - BLOOD
3 - LAP BELT ONLY USED			T - DOUBLE & TRIPLE TRAILERS	17 - PROSTHETIC AID	4 - ILLNESS	3 - URINE
4 - SHOULDER & LAP BELT USED			X - TANKER / HAZMAT	18 - OTHER	5 - FELL ASLEEP, FAINTED, FATIGUED, ETC.	4 - OTHER
5 - CHILD RESTRAINT SYSTEM - FORWARD FACING					6 - UNDER THE INFLUENCE OF MEDICATIONS / DRUGS / ALCOHOL	<b>DRUG TEST RESULT(S)</b>
6 - CHILD RESTRAINT SYSTEM - REAR FACING			<b>GENDER</b>		9 - OTHER / UNKNOWN	1 - AMPHETAMINES
7 - BOOSTER SEAT			F - FEMALE			2 - BARBITURATES
8 - HELMET USED			M - MALE			3 - BENZODIAZEPINES
9 - PROTECTIVE PADS USED (ELBOWS, KNEES, ETC)			U - OTHER / UNKNOWN			4 - CANNABINOIDS
10 - REFLECTIVE CLOTHING						5 - COCAINE
11 - LIGHTING - PEDESTRIAN / BICYCLE ONLY						6 - OPIATES / OPIOIDS
99 - OTHER / UNKNOWN						7 - OTHER
						8 - NEGATIVE RESULTS

# OCCUPANT / WITNESS ADDENDUM

LOCAL REPORT NUMBER  
49-0553-49

<b>OCCUPANT</b>	<b>UNIT #</b>	<b>NAME:</b> LAST, FIRST, MIDDLE			<b>DATE OF BIRTH</b>		<b>AGE</b>	<b>GENDER</b>	
	<b>ADDRESS:</b> STREET, CITY, STATE, ZIP				<b>CONTACT PHONE</b> - INCLUDE AREA CODE				
<b>INJURIES</b>	<b>INJURED TAKEN BY</b>	<b>EMS AGENCY (NAME)</b>	<b>INJURED TAKEN TO: MEDICAL FACILITY (NAME, CITY)</b>	<b>SAFETY EQUIPMENT</b>	<input type="checkbox"/> DOT-COMPLIANT MC HELMET	<b>SEATING POSITION</b>	<b>AIR BAG USAGE</b>	<b>EJECTION</b>	<b>TRAPPED</b>

<b>OCCUPANT</b>	<b>UNIT #</b>	<b>NAME:</b> LAST, FIRST, MIDDLE			<b>DATE OF BIRTH</b>		<b>AGE</b>	<b>GENDER</b>	
	<b>ADDRESS:</b> STREET, CITY, STATE, ZIP				<b>CONTACT PHONE</b> - INCLUDE AREA CODE				
<b>INJURIES</b>	<b>INJURED TAKEN BY</b>	<b>EMS AGENCY (NAME)</b>	<b>INJURED TAKEN TO: MEDICAL FACILITY (NAME, CITY)</b>	<b>SAFETY EQUIPMENT</b>	<input type="checkbox"/> DOT-COMPLIANT MC HELMET	<b>SEATING POSITION</b>	<b>AIR BAG USAGE</b>	<b>EJECTION</b>	<b>TRAPPED</b>

<b>OCCUPANT</b>	<b>UNIT #</b>	<b>NAME:</b> LAST, FIRST, MIDDLE			<b>DATE OF BIRTH</b>		<b>AGE</b>	<b>GENDER</b>	
	<b>ADDRESS:</b> STREET, CITY, STATE, ZIP				<b>CONTACT PHONE</b> - INCLUDE AREA CODE				
<b>INJURIES</b>	<b>INJURED TAKEN BY</b>	<b>EMS AGENCY (NAME)</b>	<b>INJURED TAKEN TO: MEDICAL FACILITY (NAME, CITY)</b>	<b>SAFETY EQUIPMENT</b>	<input type="checkbox"/> DOT-COMPLIANT MC HELMET	<b>SEATING POSITION</b>	<b>AIR BAG USAGE</b>	<b>EJECTION</b>	<b>TRAPPED</b>

<b>OCCUPANT</b>	<b>UNIT #</b>	<b>NAME:</b> LAST, FIRST, MIDDLE			<b>DATE OF BIRTH</b>		<b>AGE</b>	<b>GENDER</b>	
	<b>ADDRESS:</b> STREET, CITY, STATE, ZIP				<b>CONTACT PHONE</b> - INCLUDE AREA CODE				
<b>INJURIES</b>	<b>INJURED TAKEN BY</b>	<b>EMS AGENCY (NAME)</b>	<b>INJURED TAKEN TO: MEDICAL FACILITY (NAME, CITY)</b>	<b>SAFETY EQUIPMENT</b>	<input type="checkbox"/> DOT-COMPLIANT MC HELMET	<b>SEATING POSITION</b>	<b>AIR BAG USAGE</b>	<b>EJECTION</b>	<b>TRAPPED</b>

INJURIES	SAFETY EQUIPMENT USED	SEATING POSITION	AIR BAG USAGE
1 - FATAL 2 - SUSPECTED SERIOUS INJURY 3 - SUSPECTED MINOR INJURY 4 - POSSIBLE INJURY 5 - NO APPARENT INJURY	1 - NONE USED - VEHICLE OCCUPANT 2 - SHOULDER BELT ONLY USED 3 - LAP BELT ONLY USED 4 - SHOULDER & LAP BELT USED 5 - CHILD RESTRAINT SYSTEM - FORWARD FACING 6 - CHILD RESTRAINT SYSTEM - REAR FACING 7 - BOOSTER SEAT 8 - HELMET USED 9 - PROTECTIVE PADS USED (ELBOWS, KNEES, ETC) 10 - REFLECTIVE CLOTHING 11 - LIGHTING - PEDESTRIAN / BICYCLE ONLY 99 - OTHER / UNKNOWN	1 - FRONT - LEFT SIDE (MOTORCYCLE DRIVER) 2 - FRONT - MIDDLE 3 - FRONT - RIGHT SIDE 4 - SECOND - LEFT SIDE (MOTORCYCLE PASSENGER) 5 - SECOND - MIDDLE 6 - SECOND - RIGHT SIDE 7 - THIRD - LEFT SIDE (MOTORCYCLE SIDE CAR) 8 - THIRD - MIDDLE 9 - THIRD - RIGHT SIDE 10 - SLEEPER SECTION OF TRUCK CAB 11 - PASSENGER IN OTHER ENCLOSED CARGO AREA (NON-TRAILING UNIT SUCH AS A BUS, PICK-UP WITH CAP) 12 - PASSENGER IN UNENCLOSED CARGO AREA 13 - TRAILING UNIT 14 - RIDING ON VEHICLE EXTERIOR (NON-TRAILING UNIT) 15 - NON-MOTORIST 99 - OTHER / UNKNOWN	1 - NOT DEPLOYED 2 - DEPLOYED FRONT 3 - DEPLOYED SIDE 4 - DEPLOYED BOTH FRONT/SIDE 5 - NOT APPLICABLE 9 - DEPLOYMENT UNKNOWN
INJURED TAKEN BY			EJECTION
1 - NOT TRANSPORTED / TREATED AT SCENE 2 - EMS 3 - POLICE 9 - OTHER / UNKNOWN			1 - NOT EJECTED 2 - PARTIALLY EJECTED 3 - TOTALLY EJECTED 4 - NOT APPLICABLE
GENDER			TRAPPED
F - FEMALE M - MALE U - OTHER / UNKNOWN			1 - NOT TRAPPED 2 - EXTRICATED BY MECHANICAL MEANS 3 - FREED BY NON-MECHANICAL MEANS

<b>WITNESS</b>	<b>NAME:</b> LAST, FIRST, MIDDLE	<b>DATE OF BIRTH</b>		<b>AGE</b>	<b>GENDER</b>
	<b>ADDRESS:</b> STREET, CITY, STATE, ZIP			<b>CONTACT PHONE</b> - INCLUDE AREA CODE	

<b>WITNESS</b>	<b>NAME:</b> LAST, FIRST, MIDDLE	<b>DATE OF BIRTH</b>		<b>AGE</b>	<b>GENDER</b>
	<b>ADDRESS:</b> STREET, CITY, STATE, ZIP			<b>CONTACT PHONE</b> - INCLUDE AREA CODE	

<b>WITNESS</b>	<b>NAME:</b> LAST, FIRST, MIDDLE	<b>DATE OF BIRTH</b>		<b>AGE</b>	<b>GENDER</b>
	<b>ADDRESS:</b> STREET, CITY, STATE, ZIP			<b>CONTACT PHONE</b> - INCLUDE AREA CODE	