



TRAFFIC CRASH REPORT

LOCAL INFORMATION
P1709270002154

LOCAL REPORT NUMBER *
49-0369-49

CRASH SEVERITY
3
1 - FATAL
2 - INJURY
3 - PDO

HIT/SKIP
0
1 - SOLVED
2 - UNSOLVED

<input checked="" type="checkbox"/> PHOTOS TAKEN <input type="checkbox"/> OH-2 <input type="checkbox"/> OH-1P <input type="checkbox"/> OH-3 <input type="checkbox"/> OTHER	<input type="checkbox"/> PDO UNDER STATE REPORTABLE DOLLAR AMOUNT <input type="checkbox"/> PRIVATE PROPERTY	REPORTING AGENCY NCIC * OHP49	REPORTING AGENCY NAME * Ohio State Highway Patrol	NUMBER OF UNITS 1	UNIT IN ERROR 1 98 - ANIMAL 99 - UNKNOWN	
COUNTY * Madison County		<input type="checkbox"/> CITY * <input type="checkbox"/> VILLAGE * <input checked="" type="checkbox"/> TOWNSHIP *	CITY, VILLAGE, TOWNSHIP * Canaan (Township of)	CRASH DATE * 09/27/2017	TIME OF CRASH 13:28	DAY OF WEEK WED

DEGREES/MINUTES/SECONDS LATITUDE ..	LONGITUDE ..	DECIMAL DEGREES LATITUDE 40.054614	LONGITUDE 83.220972
---	-----------------	--	------------------------

ROADWAY DIVISION <input type="checkbox"/> DIVIDED <input checked="" type="checkbox"/> UNDIVIDED	DIVIDED LANE DIRECTION OF TRAVEL <input type="checkbox"/> N - NORTHBOUND <input type="checkbox"/> S - SOUTHBOUND <input type="checkbox"/> E - EASTBOUND <input type="checkbox"/> W - WESTBOUND	NUMBER OF THRU LANES 2	ROAD TYPES OR MILEPOST AL - ALLEY CR - CIRCLE HE - HEIGHTS MP - MILEPOST PL - PLACE ST - STREET WA - WAY AV - AVENUE CT - COURT HW - HIGHWAY PK - PARKWAY RD - ROAD TE - TERRACE BL - BOULEVARD DR - DRIVE LA - LANE PI - PIKE SQ - SQUARE TL - TRAIL
---	--	---------------------------	--

LOCATION ROUTE NUMBER <input type="checkbox"/> LOCATION ROUTE TYPE	LOC PREFIX <input type="checkbox"/> N,S, <input type="checkbox"/> E,W	LOCATION ROAD NAME Hayden Run	LOCATION ROAD TYPE <input checked="" type="checkbox"/> RD	ROUTE TYPES IR - INTERSTATE ROUTE (INC. TURNPIKE) CR - NUMBERED COUNTY ROUTE US - US ROUTE SR - STATE ROUTE TR - NUMBERED TOWNSHIP ROUTE
---	---	----------------------------------	--	--

DISTANCE FROM REFERENCE <input type="checkbox"/> MILES <input checked="" type="checkbox"/> FEET <input type="checkbox"/> YARDS 0.00	DIR FROM REF <input type="checkbox"/> N,S, <input type="checkbox"/> E,W	REFERENCE ROUTE TYPE <input type="checkbox"/> N,S, <input type="checkbox"/> E,W	REFERENCE ROUTE NUMBER <input type="checkbox"/> N,S, <input type="checkbox"/> E,W	REFERENCE NAME (ROAD, MILEPOST, HOUSE #) Carters Mill	REFERENCE ROAD TYPE <input checked="" type="checkbox"/> RD
---	---	---	---	--	---

REFERENCE POINT USED <input checked="" type="checkbox"/> 1 - INTERSECTION <input type="checkbox"/> 2 - MILE POST <input type="checkbox"/> 3 - HOUSE NUMBER	CRASH LOCATION <input checked="" type="checkbox"/> 3 01 - NOT AN INTERSECTION 02 - FOUR-WAY INTERSECTION 03 - T-INTERSECTION 04 - Y-INTERSECTION 05 - TRAFFIC CIRCLE/ ROUNDABOUT 06 - FIVE-POINT, OR MORE 07 - ON RAMP 08 - OFF RAMP 09 - CROSSOVER 10 - DRIVEWAY/ ALLEY ACCESS	<input type="checkbox"/> INTERSECTION RELATED	LOCATION OF FIRST HARMFUL EVENT <input checked="" type="checkbox"/> 4 1 - ON ROADWAY 2 - ON SHOULDER 3 - IN MEDIAN 4 - ON ROADSIDE 5 - ON GORE 6 - OUTSIDE TRAFFICWAY 9 - UNKNOWN
---	--	---	---

ROAD CONTOUR <input checked="" type="checkbox"/> 1 - STRAIGHT LEVEL <input type="checkbox"/> 2 - STRAIGHT GRADE <input type="checkbox"/> 3 - CURVE LEVEL <input type="checkbox"/> 4 - CURVE GRADE <input type="checkbox"/> 9 - UNKNOWN	ROAD CONDITIONS <input checked="" type="checkbox"/> 1 <input type="checkbox"/> 01 - DRY <input type="checkbox"/> 02 - WET <input type="checkbox"/> 03 - SNOW <input type="checkbox"/> 04 - ICE <input type="checkbox"/> 05 - SAND, MUD, DIRT, OIL, GRAVEL <input type="checkbox"/> 06 - WATER (STANDING, MOVING) <input type="checkbox"/> 07 - SLUSH <input type="checkbox"/> 08 - DEBRIS * <input type="checkbox"/> 09 - RUT, HOLES, BUMPS, UNEVEN PAVEMENT * <input type="checkbox"/> 10 - OTHER <input type="checkbox"/> 99 - UNKNOWN
---	--

MANNER OF CRASH COLLISION/IMPACT <input checked="" type="checkbox"/> 1 - NOT COLLISION BETWEEN TWO MOTOR VEHICLES IN TRANSPORT <input type="checkbox"/> 2 - REAR-END <input type="checkbox"/> 3 - HEAD-ON <input type="checkbox"/> 4 - REAR-TO-REAR <input type="checkbox"/> 5 - BACKING <input type="checkbox"/> 6 - ANGLE <input type="checkbox"/> 7 - SIDESWIPE, -SAME DIRECTION <input type="checkbox"/> 8 - SIDESWIPE, OPPOSITE DIRECTION <input type="checkbox"/> 9 - UNKNOWN	WEATHER <input checked="" type="checkbox"/> 2 <input type="checkbox"/> 1 - CLEAR <input type="checkbox"/> 2 - CLOUDY <input type="checkbox"/> 3 - FOG, SMOG, SMOKE <input type="checkbox"/> 4 - RAIN <input type="checkbox"/> 5 - SLEET, HAIL <input type="checkbox"/> 6 - SNOW <input type="checkbox"/> 7 - SEVERE CROSSWINDS <input type="checkbox"/> 8 - BLOWING SAND, SOIL, DIRT, SNOW <input type="checkbox"/> 9 - OTHER/UNKNOWN
--	---

ROAD SURFACE <input checked="" type="checkbox"/> 2 <input type="checkbox"/> 1 - CONCRETE <input type="checkbox"/> 2 - BLACKTOP, BITUMINOUS, ASPHALT <input type="checkbox"/> 3 - BRICK/BLOCK <input type="checkbox"/> 4 - SLAG, GRAVEL, STONE <input type="checkbox"/> 5 - DIRT <input type="checkbox"/> 6 - OTHER	LIGHT CONDITIONS <input checked="" type="checkbox"/> 1 <input type="checkbox"/> PRIMARY <input type="checkbox"/> SECONDARY <input type="checkbox"/> 1 - DAYLIGHT <input type="checkbox"/> 2 - DAWN <input type="checkbox"/> 3 - DUSK <input type="checkbox"/> 4 - DARK - LIGHTED ROADWAY <input type="checkbox"/> 5 - DARK - ROADWAY NOT LIGHTED <input type="checkbox"/> 6 - DARK - UNKNOWN ROADWAY LIGHTING <input type="checkbox"/> 7 - GLARE * <input type="checkbox"/> 8 - OTHER <input type="checkbox"/> 9 - UNKNOWN	<input type="checkbox"/> SCHOOL BUS RELATED <input type="checkbox"/> YES, SCHOOL BUS DIRECTLY INVOLVED <input type="checkbox"/> YES, SCHOOL BUS INDIRECTLY INVOLVED
---	--	---

<input type="checkbox"/> WORK ZONE RELATED <input type="checkbox"/> WORKERS PRESENT <input type="checkbox"/> LAW ENFORCEMENT PRESENT (OFFICER/VEHICLE) <input type="checkbox"/> LAW ENFORCEMENT PRESENT (VEHICLE ONLY)	TYPE OF WORK ZONE <input checked="" type="checkbox"/> 0 <input type="checkbox"/> 1 - LANE CLOSURE <input type="checkbox"/> 2 - LANE SHIFT/ CROSSOVER <input type="checkbox"/> 3 - WORK ON SHOULDER OR MEDIAN <input type="checkbox"/> 4 - INTERMITTENT OR MOVING WORK <input type="checkbox"/> 5 - OTHER	LOCATION OF CRASH IN WORK ZONE <input checked="" type="checkbox"/> 0 <input type="checkbox"/> 1 - BEFORE THE FIRST WORK ZONE WARNING SIGN <input type="checkbox"/> 2 - ADVANCE WARNING AREA <input type="checkbox"/> 3 - TRANSITION AREA <input type="checkbox"/> 4 - ACTIVITY AREA <input type="checkbox"/> 5 - TERMINATION AREA
---	--	---

NARRATIVE
Unit 1 was on Hayden Run Rd. and entering a soybean field and struck the guide wire for a utility pole.

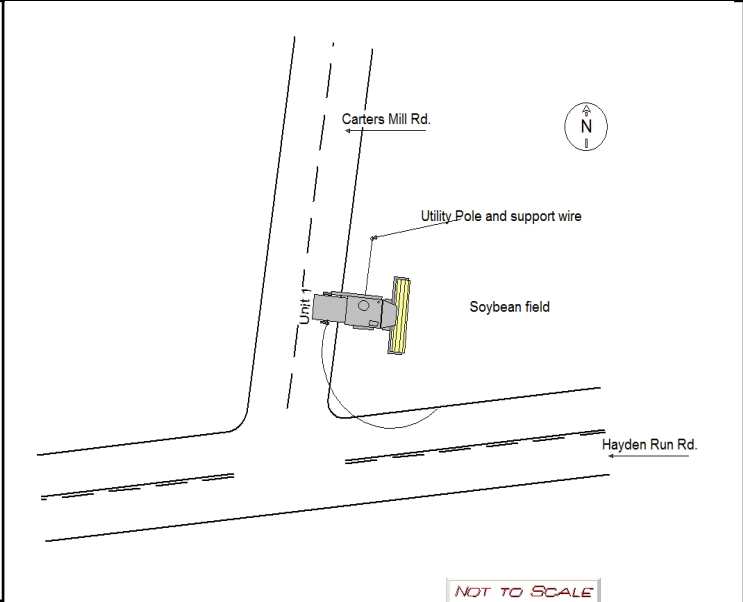

NOT TO SCALE

REPORT TAKEN BY <input checked="" type="checkbox"/> POLICE AGENCY <input type="checkbox"/> MOTORIST	<input type="checkbox"/> SUPPLEMENT (CORRECTION OR ADDITION TO AN EXISTING REPORT SENT TO ODPS)	DATE CRASH REPORTED 09/27/2017	TIME CRASH REPORTED 9/27/2017 1:28:00	DISPATCH TIME 01:28 PM	ARRIVAL TIME 01:48 PM	TIME CLEARED 02:50 PM	OTHER INVESTIGATION TIME 30	TOTAL MINUTES 112
OFFICER'S NAME * Ehrenborg, Timothy		OFFICER'S BADGE NUMBER 1441		CHECKED BY 0351				



UNIT

LOCAL REPORT NUMBER

49-0369-49

UNIT NUMBER 1	OWNER NAME: LAST, FIRST, MIDDLE (<input type="checkbox"/> SAME AS DRIVER) Becker, Gary,	OWNER PHONE NUMBER - INC. AREA CODE (<input type="checkbox"/> SAME AS DRIVER) 614-582-3598	DAMAGE SCALE 2	DAMAGE AREA FRONT REAR
OWNER ADDRESS: CITY, STATE, ZIP (<input type="checkbox"/> SAME AS DRIVER) 9681 Hayden Run Rd, Plain City, OH, 43064			1 - NONE	
LP STATE OH	LICENSE PLATE NUMBER NONE	VEHICLE IDENTIFICATION NUMBER 1HOS660SCD0755828	2 - MINOR	
VEHICLE YEAR 2012	VEHICLE MAKE DEER	VEHICLE MODEL OTH	3 - FUNCTIONAL	
PROOF OF INSURANCE SHOWN <input checked="" type="checkbox"/>	INSURANCE COMPANY Hastings Insurance	POLICY NUMBER FO 9857225	4 - DISABLING	
TOWED BY N/A			9 - UNKNOWN	

CARRIER NAME, ADDRESS, CITY, STATE, ZIP _____ CARRIER PHONE - INCLUDE AREA CODE _____

US DOT	VEHICLE WEIGHT GVWR/GCWR <input type="checkbox"/> 1 - LESS THAN OR EQUAL TO 10K LBS <input type="checkbox"/> 2 - 10,001 TO 26,000K LBS <input type="checkbox"/> 3 - MORE THAN 26,000K LBS.	CARGO BODY TYPE 1 01 - NO CARGO BODY TYPE/NOT APPLICABLE 02 - BUS/VAN (9-15 SEATS, INC DRIVER) 03 - BUS (16+ SEATS, INC DRIVER) 04 - VEHICLE TOWING ANOTHER VEHICLE 05 - LOGGING 06 - INTERMODAL CONTAINER CHASIS 07 - CARGO VAN/ENCLOSED BOX 08 - GRAIN, CHIPS, GRAVEL	09 - POLE 10 - CARGO TANK 11 - FLAT BED 12 - DUMP 13 - CONCRETE MIXER 14 - AUTO TRANSPORTER 15 - GARBAGE /REFUSE 99 - OTHER/UNKNOWN	TRAFFICWAY DESCRIPTION 1 1 - T WO-WAY, NOT DIVIDED 2 - T WO-WAY, NOT DIVIDED, CONTINUOUS LEFT TURN LANE 3 - T WO-WAY, DIVIDED, UNPROTECTED (PAINTED OR GRASS >4FT.) MEDIA 4 - T WO-WAY, DIVIDED, POSITIVE MEDIAN BARRIER 5 - ONE-WAY TRAFFICWAY
HM PLACARD ID NO.	HAZARDOUS MATERIAL <input type="checkbox"/> RELEASED			<input type="checkbox"/> HIT / SKIP UNIT
HM CLASS NUMBER				

NON-MOTORIST LOCATION PRIOR TO IMPACT <input type="checkbox"/>	TYPE OF USE 2 1 - PERSONAL 2 - COMMERCIAL 3 - GOVERNMENT <input type="checkbox"/> IN EMERGENCY RESPONSE	UNIT TYPE 20 99 - UNKNOWN OR HIT/SKIP	PASSENGER VEHICLES (LESS THAN 9 PASSENGERS) 01 - SUB-COMPACT 02 - COMPACT 03 - MID SIZE 04 - FULL SIZE 05 - MINIVAN 06 - SPORT UTILITY VEHICLE 07 - PICKUP 08 - VAN 09 - MOTORCYCLE 10 - MOTORIZED BICYCLE 11 - SNOWMOBILE/ATV 12 - OTHER PASSENGER VEHICLE	MED/HEAVY TRUCKS OR COMBO UNITS > 10K LBS BUS/VAN/LMO (9 OR MORE INCLUDING DRIVER) 13 - SINGLE UNIT TRUCK OR VAN 2AXLE, 6 TIRES 14 - SINGLE UNIT TRUCK, 3+ AXLES 15 - SINGLE UNIT TRUCK / TRAILER 16 - TRUCK/TRACTOR (BOBTAIL) 17 - TRACTOR/SEMI-TRAILER 18 - TRACTOR/DOUBLE 19 - TRACTOR/TRIPLES 20 - OTHER MED/HEAVY VEHICLE	21 - BUS/VAN (9-15 SEATS, INC DRIVER) 22 - BUS (16+ SEATS, INC DRIVER) NON-MOTORIST 23 - ANIMAL WITH RIDER 24 - ANIMAL WITH BUGGY, WAGON, SURREY 25 - BICYCLE/PEDACYCLIST 26 - PEDESTRIAN/SKATER 27 - OTHER NON-MOTORIST
<input type="checkbox"/> HAS HM PLACARD					

SPECIAL FUNCTION 18 01 - NONE 02 - TAXI 03 - RENTAL TRUCK (OVER 10K LBS) 04 - BUS - SCHOOL (PUBLIC OR PRIVATE) 05 - BUS - TRANSIT 06 - BUS - CHARTER 07 - BUS - SHUTTLE 08 - BUS - OTHER	09 - AMBULANCE 10 - FIRE 11 - HIGHWAY MAINTENANCE 12 - MILITARY 13 - POLICE 14 - PUBLIC UTILITY 15 - OTHER GOVERNMENT 16 - CONSTRUCTION EQUIP.	17 - FARM VEHICLE 18 - FARM EQUIPMENT 19 - MOTORHOME 20 - GOLF CART 21 - TRAIN 22 - OTHER (EXPLAIN IN NARRATIVE)	MOST DAMAGED AREA 9 01 - NONE 02 - CENTER FRONT 03 - RIGHT FRONT 04 - RIGHT SIDE 05 - RIGHT REAR 06 - REAR CENTER 07 - LEFT REAR	08 - LEFT SIDE 09 - LEFT FRONT 10 - TOP AND WINDOWS 11 - UNDERCARRIAGE 12 - LOAD/TRAILER 13 - TOTAL (ALL AREAS) 14 - OTHER	99 - UNKNOWN	ACTION 3 1 - NON-CONTACT 2 - NON-COLLISION 3 - STRIKING 4 - STRUCK 5 - STRIKING/STRUCK 9 - UNKNOWN
--	---	---	---	--	--------------	--

PRE-CRASH ACTIONS 14 99 - UNKNOWN	MOTORIST 01 - STRAIGHT AHEAD 02 - BACKING 03 - CHANGING LANES 04 - OVERTAKING/PASSING 05 - MAKING RIGHT TURN 06 - MAKING LEFT TURN	07 - MAKING U-TURN 08 - ENTERING TRAFFIC LANE 09 - LEAVING TRAFFIC LANE 10 - PARKED 11 - SLOWING OR STOPPED IN TRAFFIC 12 - DRIVERLESS	13 - NEGOTIATING A CURVE 14 - OTHER MOTORIST ACTION	NON-MOTORIST 15 - ENTERING OR CROSSING SPECIFIED LOCATION 16 - WALKING, RUNNING, JOGGING, PLAYING, CYCLING 17 - WORKING 18 - PUSHING VEHICLE 19 - APPROACHING OR LEAVING VEHICLE 20 - STANDING	21 - OTHER NON-MOTORIST ACTION
--	--	---	--	--	--------------------------------

CONTRIBUTING CIRCUMSTANCE PRIMARY 21 SECONDARY <input type="checkbox"/> 99 - UNKNOWN	MOTORIST 01 - NONE 02 - FAILURE TO YIELD 03 - RAN RED LIGHT 04 - RAN STOP SIGN 05 - EXCEEDED SPEED LIMIT 06 - UNSAFE SPEED 07 - IMPROPER TURN 08 - LEFT OF CENTER 09 - FOLLOWED TOO CLOSELY/ACDA 10 - IMPROPER LANE CHANGE /PASSING/OFF ROAD	11 - IMPROPER BACKING 12 - IMPROPER START FROM PARKED POSITION 13 - STOPPED OR PARKED ILLEGALLY 14 - OPERATING VEHICLE IN NEGLIGENT MANNER 15 - SWERVING TO AVOID (DUE TO EXTERNAL CONDITIONS) 16 - WRONG SIDE/WRONG WAY 17 - FAILURE TO CONTROL 18 - VISION OBSTRUCTION 19 - OPERATING DEFECTIVE EQUIPMENT 20 - LOAD SHIFTING/FALLING/SPILLING 21 - OTHER IMPROPER ACTION	NON-MOTORIST 22 - NONE 23 - IMPROPER CROSSING 24 - DARTING 25 - LYING AND/OR ILLEGALLY IN ROADWAY 26 - FAILURE TO YIELD RIGHT OF WAY 27 - NOT VISIBLE (DARK CLOTHING) 28 - INATTENTIVE 29 - FAILURE TO OBEY TRAFFIC SIGNS /SIGNALS/OFFICER 30 - WRONG SIDE OF THE ROAD 31 - OTHER NON-MOTORIST ACTION	VEHICLE DEFECTS <input type="checkbox"/> 01 - TURN SIGNALS 02 - HEAD LAMPS 03 - TAIL LAMPS 04 - BRAKES 05 - STEERING 06 - TIRE BLOWOUT 07 - WORN OR SLICK TIRES 08 - TRAILER EQUIPMENT DEFECTIVE 09 - MOTOR TROUBLE 10 - DISABLED FROM PRIOR ACCIDENT 11 - OTHER DEFECTS
--	--	--	---	--

SEQUENCE OF EVENTS 1 8 2 41 3 <input type="checkbox"/> 4 <input type="checkbox"/> 5 <input type="checkbox"/> 6 <input type="checkbox"/> FIRST HARMFUL EVENT 2 MOST HARMFUL EVENT 2 99 - UNKNOWN	NON-COLLISION EVENTS 01 - OVERTURN/ROLLOVER 02 - FIRE/EXPLOSION 03 - IMMERSION 04 - JACKKNIFE 05 - CARGO/EQUIPMENT LOSS OR SHIFT 06 - EQUIPMENT FAILURE (BLOWN TIRE, BRAKE FAILURE, ETC) 07 - SEPARATION OF UNITS 08 - RAN OFF ROAD RIGHT 09 - RAN OFF ROAD LEFT	10 - CROSS MEDIAN 11 - CROSS CENTER LINE OPPOSITE DIRECTION OF TRAVEL 12 - DOWNHILL RUNAWAY 13 - OTHER NON-COLLISION
COLLISION WITH PERSON, VEHICLE OR OBJECT NOT FIXED 14 - PEDESTRIAN 15 - PEDALCYCLE 16 - RAILWAY VEHICLE (TRAIN, ENGINE) 17 - ANIMAL - FARM 18 - ANIMAL - DEER 19 - ANIMAL - OTHER 20 - MOTOR VEHICLE IN TRANSPORT 21 - PARKED MOTOR VEHICLE 22 - WORK ZONE MAINTENANCE EQUIPMENT 23 - STRUCK BY FALLING, SHIFTING CARGO OR ANYTHING SET IN MOTION BY A MOTOR VEHICLE 24 - OTHER MOVABLE OBJECT 25 - IMPACT ATTENUATOR/CRASH CUSHION 26 - BRIDGE OVERHEAD STRUCTURE 27 - BRIDGE PIER OR ABUTMENT 28 - BRIDGE PARAPET 29 - BRIDGE RAIL 30 - GUARDRAIL FACE 31 - GUARDRAIL END 32 - PORTABLE BARRIER 33 - MEDIAN CABLE BARRIER 34 - MEDIAN GUARDRAIL BARRIER 35 - MEDIAN CONCRETE BARRIER 36 - MEDIAN OTHER BARRIER 37 - TRAFFIC SIGN POST 38 - OVERHEAD SIGN POST 39 - LIGHT/LUMINARIES SUPPORT 40 - UTILITY POLE 41 - OTHER POST, POLE OR SUPPORT 42 - CULVART 43 - CURB 44 - DITCH 45 - EMBANKMENT 46 - FENCE 47 - MAILBOX 48 - TREE 49 - FIRE HYDRANT 50 - WORK ZONE MAINTENANCE EQUIPMENT 51 - WALL, BUILDING, TUNNEL 52 - OTHER FIXED OBJECT		

UNIT SPEED <input type="checkbox"/> STATED <input type="checkbox"/> ESTIMATED	POSTED SPEED 55	TRAFFIC CONTROL 1 01 - NO CONTROLS 02 - STOP SIGN 03 - YIELD SIGN 04 - TRAFFIC SIGNAL 05 - TRAFFIC FLASHERS 06 - SCHOOL ZONE 07 - RAILROAD CROSSBUCKS 08 - RAILROAD FLASHERS 09 - RAILROAD GATES 10 - CONSTRUCTION BARRICADE 11 - PERSON (FLAGGER, OFFICER) 12 - PAVEMENT MARKINGS	UNIT DIRECTION FROM 2 TO 3 1 - NORTH 2 - SOUTH 3 - EAST 4 - WEST 5 - NORTHEAST 6 - NORTHWEST 7 - SOUTHEAST 8 - SOUTHWEST 9 - UNKNOWN
---	---------------------------	--	--



MOTORIST / NON-MOTORIST / OCCUPANT

LOCAL REPORT NUMBER

49-0369-49

UNIT NUMBER 1	NAME: LAST, FIRST, MIDDLE Becker, Gary				DATE OF BIRTH 05/14/1957	AGE 60	GENDER <input checked="" type="checkbox"/> M F - FEMALE M - MALE				
ADDRESS, CITY, STATE, ZIP 9681 Hayden Run Rd, Plain City, OH, 43064						CONTACT PHONE - INCLUDE AREA CODE 614-582-3598					
INJURIES <input checked="" type="checkbox"/>	INJURED TAKEN BY <input checked="" type="checkbox"/>	EMS AGENCY		MEDICAL FACILITY INJURED TAKEN TO	SAFETY EQUIPMENT USED 1	DOT COMPLIANT <input type="checkbox"/> MOTORCYCLE <input type="checkbox"/> HELMET	SEATING POSITION <input checked="" type="checkbox"/> 1	AIR BAG USAGE <input checked="" type="checkbox"/> 5	EJECTION <input checked="" type="checkbox"/> 1	TRAPPED <input checked="" type="checkbox"/> 1	
OL STATE OH	OPERATOR LICENSE NUMBER	OL CLASS <input checked="" type="checkbox"/> 4	No <input type="checkbox"/> VALID DL	M/C <input type="checkbox"/> END	CONDITION <input checked="" type="checkbox"/> 1	ALCOHOL/DRUG SUSPECTED <input checked="" type="checkbox"/> 1	ALCOHOL TEST STATUS <input checked="" type="checkbox"/> 1	ALCOHOL TEST TYPE <input checked="" type="checkbox"/> 1	ALCOHOL TEST VALUE	DRUG TEST STATUS 1	DRUG TEST TYPE 1
OFFENSE CHARGED (<input type="checkbox"/> LOCAL CODE)		OFFENSE DESCRIPTION			CITATION NUMBER		HANDS-FREE <input type="checkbox"/> DEVICE USED		DRIVER DISTRACTED BY <input checked="" type="checkbox"/> 1		
UNIT NUMBER	NAME: LAST, FIRST, MIDDLE				DATE OF BIRTH	AGE	GENDER <input type="checkbox"/> F - FEMALE M - MALE				
ADDRESS, CITY, STATE, ZIP						CONTACT PHONE - INCLUDE AREA CODE					
INJURIES <input type="checkbox"/>	INJURED TAKEN BY <input type="checkbox"/>	EMS AGENCY		MEDICAL FACILITY INJURED TAKEN TO	SAFETY EQUIPMENT USED	DOT COMPLIANT <input type="checkbox"/> MOTORCYCLE <input type="checkbox"/> HELMET	SEATING POSITION	AIR BAG USAGE	EJECTION	TRAPPED	
OL STATE	OPERATOR LICENSE NUMBER	OL CLASS <input type="checkbox"/>	No <input type="checkbox"/> VALID DL	M/C <input type="checkbox"/> END	CONDITION <input type="checkbox"/>	ALCOHOL/DRUG SUSPECTED <input type="checkbox"/>	ALCOHOL TEST STATUS <input type="checkbox"/>	ALCOHOL TEST TYPE <input type="checkbox"/>	ALCOHOL TEST VALUE	DRUG TEST STATUS	DRUG TEST TYPE
OFFENSE CHARGED (<input type="checkbox"/> LOCAL CODE)		OFFENSE DESCRIPTION			CITATION NUMBER		HANDS-FREE <input type="checkbox"/> DEVICE USED		DRIVER DISTRACTED BY <input type="checkbox"/>		
INJURIES		INJURED TAKEN BY		SAFETY EQUIPMENT USED		99 - UNKNOWN SAFETY EQUIPMENT					
1 - NO INJURY / NONE REPORTED 2 - POSSIBLE 3 - NON-INCAPACITATING 4 - INCAPACITATING 5 - FATAL		1 - NOT TRANSPORTED / TREATED AT SCENE 2 - EMS 3 - POLICE 4 - OTHER 9 - UNKNOWN		MOTORIST 01 - NONE USED - VEHICLE OCCUPANT 02 - SHOULDER BELT ONLY USED 03 - LAP BELT ONLY USED 04 - SHOULDER AND LAP BELT ONLY USED		NON-MOTORIST 05 - CHILD RESTRAINT SYSTEM-FORWARD FACING 06 - CHILD RESTRAINT SYSTEM-REAR FACING 07 - BOOSTER SEAT 08 - HELMET USED		09 - NONE USED 10 - HELMET USED 11 - PROTECTIVE PADS USED (ELBOWS, KNEES, ETC)		12 - REFLECTIVE COATING 13 - LIGHTING 14 - OTHER	
SEATING POSITION						AIR BAG USAGE					
01 - FRONT - LEFT SIDE (MOTORCYCLE DRIVER) 02 - FRONT - MIDDLE 03 - FRONT - RIGHT SIDE 04 - SECOND - LEFT SIDE (MOTORCYCLE PASSENGER) 05 - SECOND - MIDDLE 06 - SECOND - RIGHT SIDE						07 - THIRD - LEFT SIDE (MOTORCYCLE SIDE CAR) 08 - THIRD - MIDDLE 09 - THIRD - RIGHT SIDE 10 - SLEEPER SECTION OF CAB (TRUCK) 11 - PASSENGER IN OTHER ENCLOSED CARGO AREA (NON-TRAILING UNIT SUCH AS A BUS, PICKUP WITH CAP)			12 - PASSENGER IN UNENCLOSED CARGO AREA 13 - TRAILING UNIT 14 - RIDING ON VEHICLE EXTERIOR (NON-TRAILING UNIT) 15 - NON-MOTORIST 16 - OTHER 99 - UNKNOWN		
EJECTION		TRAPPED		OPERATOR LICENSE CLASS		CONDITION		ALCOHOL/DRUG SUSPECTED			
1 - NOT EJECTED 2 - TOTALLY EJECTED 3 - PARTIALLY EJECTED 4 - NOT APPLICABLE		1 - NOT TRAPPED 2 - EXTRICATED BY MECHANICAL MEANS 3 - EXTRICATED BY NON-MECHANICAL MEANS		1 - CLASS A 2 - CLASS B 3 - CLASS C 4 - REGULAR CLASS (OHIO'S "D") 5 - MC/MOPED ONLY		1 - APPARENTLY NORMAL 2 - PHYSICAL IMPAIRMENT 3 - EMOTIONAL (DEPRESSED, ANGRY, DISTURBED) 4 - ILLNESS		5 - FELL ASLEEP, FAINTED, FATIGUE 6 - UNDER THE INFLUENCE OF MEDICATIONS, DRUGS, ALCOHOL 7 - OTHER			
ALCOHOL TEST STATUS		ALCOHOL TEST TYPE		DRUG TEST STATUS		DRUG TEST TYPE		DRIVER DISTRACTED BY			
1 - NONE GIVEN 2 - TEST REFUSED 3 - TEST GIVEN, CONTAMINATED SAMPLE/UNUSABLE 4 - TEST GIVEN, RESULTS KNOWN 5 - TEST GIVEN, RESULTS UNKNOWN		1 - NONE 2 - BLOOD 3 - URINE 4 - BREATH 5 - OTHER		1 - NONE GIVEN 2 - TEST REFUSED 3 - TEST GIVEN, CONTAMINATED SAMPLE/UNUSABLE 4 - TEST GIVEN, RESULTS KNOWN 5 - TEST GIVEN, RESULTS UNKNOWN		1 - NONE 2 - BLOOD 3 - URINE 4 - OTHER		1 - NO DISTRACTION REPORTED 2 - PHONE 3 - TEXTING/EMAILING 4 - ELECTRONIC COMMUNICATION DEVICE (NAVIGATION DEVICE, RADIO, DVD) 6 - OTHER INSIDE THE VEHICLE 7 - EXTERNAL DISTRACTION			
UNIT NUMBER	NAME: LAST, FIRST, MIDDLE				DATE OF BIRTH	AGE	GENDER <input type="checkbox"/> F - FEMALE M - MALE				
ADDRESS, CITY, STATE, ZIP						CONTACT PHONE - INCLUDE AREA CODE					
INJURIES <input type="checkbox"/>	INJURED TAKEN BY <input type="checkbox"/>	EMS AGENCY		MEDICAL FACILITY INJURED TAKEN TO	SAFETY EQUIPMENT USED	DOT COMPLIANT <input type="checkbox"/> MOTORCYCLE <input type="checkbox"/> HELMET	SEATING POSITION	AIR BAG USAGE	EJECTION	TRAPPED	
UNIT NUMBER	NAME: LAST, FIRST, MIDDLE				DATE OF BIRTH	AGE	GENDER <input type="checkbox"/> F - FEMALE M - MALE				
ADDRESS, CITY, STATE, ZIP						CONTACT PHONE - INCLUDE AREA CODE					
INJURIES <input type="checkbox"/>	INJURED TAKEN BY <input type="checkbox"/>	EMS AGENCY		MEDICAL FACILITY INJURED TAKEN TO	SAFETY EQUIPMENT USED	DOT COMPLIANT <input type="checkbox"/> MOTORCYCLE <input type="checkbox"/> HELMET	SEATING POSITION	AIR BAG USAGE	EJECTION	TRAPPED	

MOTORIST/NON-MOTORIST

MOTORIST/NON-MOTORIST

OCCUPANT

OCCUPANT