

TRAFFIC CRASH REPORT

*DENOTES MANDATORY FIELD FOR SUPPLEMENT REPORT

LOCAL REPORT NUMBER *
2025000000565

<input checked="" type="checkbox"/> PHOTOS TAKEN <input type="checkbox"/> SECONDARY CRASH		<input type="checkbox"/> OH -2 <input type="checkbox"/> OH -1P <input type="checkbox"/> PRIVATE PROPERTY		<input checked="" type="checkbox"/> OH -3 <input type="checkbox"/> OTHER		LOCAL INFORMATION REPORTING AGENCY NAME * MADISON COUNTY SHERIFF		NCIC * 04900		HIT/SKIP <input type="checkbox"/> 1 - SOLVED <input type="checkbox"/> 2 - UNSOLVED	NUMBER OF UNITS 1	UNIT IN ERROR <input type="checkbox"/> 98 - ANIMAL <input type="checkbox"/> 99 - UNKNOWN
COUNTY* 49	LOCALITY* <input type="checkbox"/> 1 - CITY <input checked="" type="checkbox"/> 3 - TOWNSHIP	LOCATION: CITY, VILLAGE, TOWNSHIP* FAIRFIELD (TOWNSHIP OF)				CRASH DATE / TIME* 03/20/2025 16:29		CRASH SEVERITY <input checked="" type="checkbox"/> 1 - FATAL <input type="checkbox"/> 2 - SERIOUS INJURY SUSPECTED <input type="checkbox"/> 3 - MINOR INJURY SUSPECTED <input type="checkbox"/> 4 - INJURY POSSIBLE <input type="checkbox"/> 5 - PROPERTY DAMAGE ONLY				
ROUTE TYPE <input type="checkbox"/> 1 - NORTH <input type="checkbox"/> 2 - SOUTH <input type="checkbox"/> 3 - EAST <input type="checkbox"/> 4 - WEST	ROUTE NUMBER <input type="checkbox"/> 1 - NORTH <input checked="" type="checkbox"/> 2 - SOUTH <input type="checkbox"/> 3 - EAST <input type="checkbox"/> 4 - WEST	PREFIX <input type="checkbox"/> 1 - NORTH <input type="checkbox"/> 2 - SOUTH <input type="checkbox"/> 3 - EAST <input type="checkbox"/> 4 - WEST	LOCATION ROAD NAME BIG PLAIN-CIRCLEVILLE SE			ROAD TYPE RD	LATITUDE DECIMAL DEGREES 39.836545		INTERSECTION RELATED <input type="checkbox"/> WITHIN INTERSECTION OR ON APPROACH <input type="checkbox"/> WITHIN INTERCHANGE AREA NUMBER OF APPROACHES			
ROUTE TYPE <input type="checkbox"/> 1 - NORTH <input type="checkbox"/> 2 - SOUTH <input type="checkbox"/> 3 - EAST <input type="checkbox"/> 4 - WEST	ROUTE NUMBER <input type="checkbox"/> 1 - NORTH <input checked="" type="checkbox"/> 2 - SOUTH <input type="checkbox"/> 3 - EAST <input type="checkbox"/> 4 - WEST	PREFIX <input type="checkbox"/> 1 - NORTH <input type="checkbox"/> 2 - SOUTH <input type="checkbox"/> 3 - EAST <input type="checkbox"/> 4 - WEST	REFERENCE ROAD NAME (ROAD, MILEPOST, HOUSE #) 9241			ROAD TYPE	LONGITUDE DECIMAL DEGREES -83.278812					
REFERENCE POINT <input checked="" type="checkbox"/> 1 - INTERSECTION <input type="checkbox"/> 2 - MILE POST <input type="checkbox"/> 3 - HOUSE #	DIRECTION FROM REFERENCE <input checked="" type="checkbox"/> 1 - NORTH <input type="checkbox"/> 2 - SOUTH <input type="checkbox"/> 3 - EAST <input type="checkbox"/> 4 - WEST	ROUTE TYPE IR - INTERSTATE ROUTE (TP) US - FEDERAL US ROUTE SR - STATE ROUTE CR - NUMBERED COUNTY ROUTE TR - NUMBERED TOWNSHIP ROUTE	ROAD TYPE AL - ALLEY AV - AVENUE BL - BOULEVARD CR - CIRCLE CT - COURT DR - DRIVE HE - HEIGHTS	ROAD TYPE HW - HIGHWAY LA - LANE MP - MILEPOST OV - OVAL PK - PARKWAY PI - PIKE PL - PLACE	ROAD TYPE RD - ROAD SQ - SQUARE ST - STREET TE - TERRACE TL - TRAIL WA - WAY	ROADWAY <input type="checkbox"/> ROADWAY DIVIDED						
LOCATION OF FIRST HARMFUL EVENT <input checked="" type="checkbox"/> 1 - ON ROADWAY <input type="checkbox"/> 2 - ON SHOULDER <input type="checkbox"/> 3 - IN MEDIAN <input type="checkbox"/> 4 - ON ROADSIDE <input type="checkbox"/> 5 - ON GORE <input type="checkbox"/> 6 - OUTSIDE TRAFFIC WAY <input type="checkbox"/> 7 - ON RAMP <input type="checkbox"/> 8 - OFF RAMP	DIRECTION FROM REFERENCE <input checked="" type="checkbox"/> 1 - NORTH <input type="checkbox"/> 2 - SOUTH <input type="checkbox"/> 3 - EAST <input type="checkbox"/> 4 - WEST	ROUTE TYPE IR - INTERSTATE ROUTE (TP) US - FEDERAL US ROUTE SR - STATE ROUTE CR - NUMBERED COUNTY ROUTE TR - NUMBERED TOWNSHIP ROUTE	ROAD TYPE AL - ALLEY AV - AVENUE BL - BOULEVARD CR - CIRCLE CT - COURT DR - DRIVE HE - HEIGHTS	ROAD TYPE HW - HIGHWAY LA - LANE MP - MILEPOST OV - OVAL PK - PARKWAY PI - PIKE PL - PLACE	ROAD TYPE RD - ROAD SQ - SQUARE ST - STREET TE - TERRACE TL - TRAIL WA - WAY	MANNER OF CRASH COLLISION/IMPACT <input checked="" type="checkbox"/> 1 - NOT COLLISION BETWEEN TWO MOTOR VEHICLES IN TRANSPORT <input type="checkbox"/> 2 - REAR-END <input type="checkbox"/> 3 - HEAD-ON <input type="checkbox"/> 4 - REAR-TO-REAR <input type="checkbox"/> 5 - BACKING <input type="checkbox"/> 6 - ANGLE <input type="checkbox"/> 7 - SIDESWIPE, SAME DIRECTION <input type="checkbox"/> 8 - SIDESWIPE, OPPOSITE DIRECTION <input type="checkbox"/> 9 - OTHER / UNKNOWN	DIRECTION OF TRAVEL <input type="checkbox"/> 1 - NORTH <input type="checkbox"/> 2 - SOUTH <input type="checkbox"/> 3 - EAST <input type="checkbox"/> 4 - WEST	MEDIAN TYPE <input type="checkbox"/> 1 - DIVIDED FLUSH MEDIAN (< 4 FEET) <input type="checkbox"/> 2 - DIVIDED FLUSH MEDIAN (≥ 4 FEET) <input type="checkbox"/> 3 - DIVIDED, DEPRESSED MEDIAN <input type="checkbox"/> 4 - DIVIDED, RAISED MEDIAN (ANY TYPE) <input type="checkbox"/> 9 - OTHER / UNKNOWN				
<input type="checkbox"/> WORK ZONE RELATED <input type="checkbox"/> WORKERS PRESENT <input type="checkbox"/> LAW ENFORCEMENT PRESENT <input type="checkbox"/> ACTIVE SCHOOL ZONE	WORK ZONE TYPE <input type="checkbox"/> 1 - LANE CLOSURE <input type="checkbox"/> 2 - LANE SHIFT/ CROSSOVER <input type="checkbox"/> 3 - WORK ON SHOULDER OR MEDIAN <input type="checkbox"/> 4 - INTERMITTENT OR MOVING WORK <input type="checkbox"/> 5 - OTHER	LOCATION OF CRASH IN WORK ZONE <input type="checkbox"/> 1 - BEFORE THE 1ST WORK ZONE WARNING SIGN <input type="checkbox"/> 2 - ADVANCE WARNING AREA <input type="checkbox"/> 3 - TRANSITION AREA <input type="checkbox"/> 4 - ACTIVITY AREA <input type="checkbox"/> 5 - TERMINATION AREA	CONTOUR <input checked="" type="checkbox"/> 4 1 - STRAIGHT LEVEL 2 - STRAIGHT GRADE 3 - CURVE LEVEL 4 - CURVE GRADE 9 - OTHER /UNKNOWN	CONDITIONS <input checked="" type="checkbox"/> 1 1 - DRY 2 - WET 3 - SNOW 4 - ICE 5 - SAND, MUD, DIRT, OIL, GRAVEL 6 - WATER (STANDING, MOVING) 7 - SLUSH 9 - OTHER / UNKNOWN	SURFACE <input checked="" type="checkbox"/> 2 1 - CONCRETE 2 - BLACKTOP, BITUMINOUS, ASPHALT 3 - BRICK/BLOCK 4 - SLAG, GRAVEL, STONE 5 - DIRT 9 - OTHER / UNKNOWN							
LIGHT CONDITION <input checked="" type="checkbox"/> 1 1 - DAYLIGHT 2 - DAWN/DUSK 3 - DARK - LIGHTED ROADWAY 4 - DARK - ROADWAY NOT LIGHTED 5 - DARK - UNKNOWN ROADWAY LIGHTING 9 - OTHER / UNKNOWN	WEATHER <input checked="" type="checkbox"/> 2 1 - CLEAR 2 - CLOUDY 3 - FOG, SMOG, SMOKE 4 - RAIN 5 - SLEET, HAIL 6 - SNOW 7 - SEVERE CROSSWINDS 8 - BLOWING SAND, SOIL, DIRT, SNOW 9 - FREEZING RAIN OR FREEZING DRIZZLE 99 - OTHER / UNKNOWN	NARRATIVE Unit 1 was going around the curb near 9241 Big-Plain Circleville Road. Unit 1 lost control and ran off the road left into a field.										
CRASH REPORTED DATE / TIME 03/20/2025 16:29	DISPATCH DATE / TIME 03/20/2025 16:31	ARRIVAL DATE / TIME 03/20/2025 16:40	SCENE CLEARED DATE / TIME 03/20/2025 17:08	REPORT TAKEN BY <input checked="" type="checkbox"/> POLICE AGENCY <input type="checkbox"/> MOTORIST								
TOTAL TIME ROADWAY CLOSED 0	OTHER INVESTIGATION TIME 0	TOTAL MINUTES 37	OFFICER'S NAME* MAGANA, MARIA D	CHECKED BY OFFICER'S NAME* HUDDLESTON, BRYAN S								
OFFICER'S BADGE NUMBER* 000042	CHECKED BY OFFICER'S BADGE NUMBER* 000005	<input type="checkbox"/> SUPPLEMENT (CORRECTION OR ADDITION TO AN EXISTING REPORT SENT TO ODPS)										

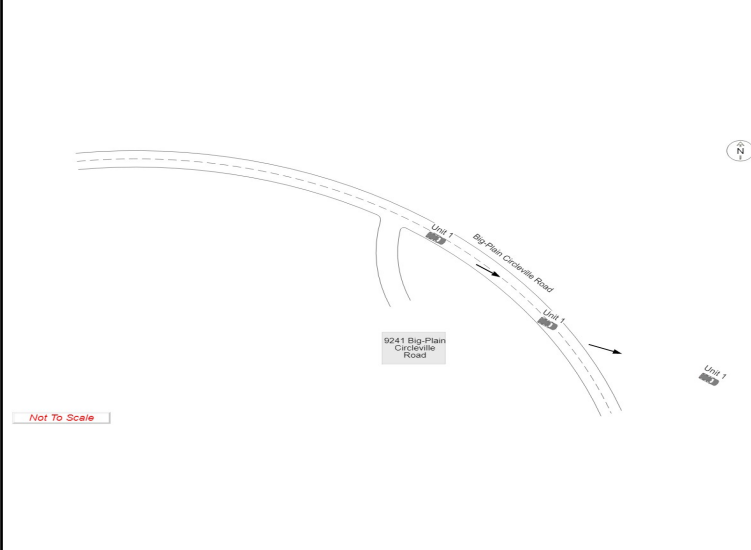

UNIT # 1	OWNER NAME: LAST, FIRST, MIDDLE (☐ SAME AS DRIVER) HICKS, GARNETT, R	OWNER PHONE: INCLUDE AREA CODE (☐ SAME AS DRIVER)
OWNER ADDRESS: STREET, CITY, STATE, ZIP (☐ SAME AS DRIVER) 7038 BIGGERT RD, LONDON, OH, 43140		
COMMERCIAL CARRIER: NAME, ADDRESS, CITY, STATE, ZIP		COMMERCIAL CARRIER PHONE: INCLUDE AREA CODE

LP STATE OH	LICENSE PLATE # FLF2918	VEHICLE IDENTIFICATION # KNDJN2A22G7357554	VEHICLE YEAR 2016	VEHICLE MAKE KIA																														
<input checked="" type="checkbox"/> INSURANCE VERIFIED	INSURANCE COMPANY GEICO	INSURANCE POLICY # 4516-04-95-43	COLOR GRY	VEHICLE MODEL SOUL																														
TYPE OF USE <input type="checkbox"/> COMMERCIAL <input type="checkbox"/> GOVERNMENT <input type="checkbox"/> IN EMERGENCY RESPONSE		US DOT #	TOWED BY: COMPANY NAME SMITHS TOWING																															
<input type="checkbox"/> INTERLOCK DEVICE EQUIPPED	<input type="checkbox"/> HIT/SKIP UNIT	VEHICLE WEIGHT GVWR/GCWR 1 - ≤10K LBS. 2 - 10.001 - 26K LBS. 3 - > 26K LBS.	HAZARDOUS MATERIAL <input type="checkbox"/> MATERIAL CLASS # <input type="checkbox"/> RELEASED <input type="checkbox"/> PLACARD PLACARD ID #																															
UNIT TYPE 1	<table border="0"> <tr> <td>1 - PASSENGER CAR</td> <td>6 - VAN (9-15 SEATS)</td> <td>12 - GOLF CART</td> <td>18 - LIMO (LIVERY VEHICLE)</td> <td>23 - PEDESTRIAN/SKATER</td> </tr> <tr> <td>2 - PASSENGER VAN (MINIVAN)</td> <td>7 - MOTORCYCLE 2-WHEELED</td> <td>13 - SNOWMOBILE</td> <td>19 - BUS (16+ PASSENGERS)</td> <td>24 - WHEELCHAIR (ANY TYPE)</td> </tr> <tr> <td>3 - SPORT UTILITY VEHICLE</td> <td>8 - MOTORCYCLE 3-WHEELED</td> <td>14 - SINGLE UNIT TRUCK</td> <td>20 - OTHER VEHICLE</td> <td>25 - OTHER NON-MOTORIST</td> </tr> <tr> <td>4 - PICK UP</td> <td>9 - AUTOCYCLE</td> <td>15 - SEMI-TRACTOR</td> <td>21 - HEAVY EQUIPMENT</td> <td>26 - BICYCLE</td> </tr> <tr> <td>5 - CARGO VAN</td> <td>10 - MOPED OR MOTORIZED BICYCLE</td> <td>16 - FARM EQUIPMENT</td> <td>22 - ANIMAL WITH RIDER OR ANIMAL-DRAWN VEHICLE</td> <td>27 - TRAIN</td> </tr> <tr> <td></td> <td>11 - ALL TERRAIN VEHICLE (ATV/UTV)</td> <td>17 - MOTORHOME</td> <td>99 - UNKNOWN OR HIT/SKIP</td> <td></td> </tr> </table>				1 - PASSENGER CAR	6 - VAN (9-15 SEATS)	12 - GOLF CART	18 - LIMO (LIVERY VEHICLE)	23 - PEDESTRIAN/SKATER	2 - PASSENGER VAN (MINIVAN)	7 - MOTORCYCLE 2-WHEELED	13 - SNOWMOBILE	19 - BUS (16+ PASSENGERS)	24 - WHEELCHAIR (ANY TYPE)	3 - SPORT UTILITY VEHICLE	8 - MOTORCYCLE 3-WHEELED	14 - SINGLE UNIT TRUCK	20 - OTHER VEHICLE	25 - OTHER NON-MOTORIST	4 - PICK UP	9 - AUTOCYCLE	15 - SEMI-TRACTOR	21 - HEAVY EQUIPMENT	26 - BICYCLE	5 - CARGO VAN	10 - MOPED OR MOTORIZED BICYCLE	16 - FARM EQUIPMENT	22 - ANIMAL WITH RIDER OR ANIMAL-DRAWN VEHICLE	27 - TRAIN		11 - ALL TERRAIN VEHICLE (ATV/UTV)	17 - MOTORHOME	99 - UNKNOWN OR HIT/SKIP	
1 - PASSENGER CAR	6 - VAN (9-15 SEATS)	12 - GOLF CART	18 - LIMO (LIVERY VEHICLE)	23 - PEDESTRIAN/SKATER																														
2 - PASSENGER VAN (MINIVAN)	7 - MOTORCYCLE 2-WHEELED	13 - SNOWMOBILE	19 - BUS (16+ PASSENGERS)	24 - WHEELCHAIR (ANY TYPE)																														
3 - SPORT UTILITY VEHICLE	8 - MOTORCYCLE 3-WHEELED	14 - SINGLE UNIT TRUCK	20 - OTHER VEHICLE	25 - OTHER NON-MOTORIST																														
4 - PICK UP	9 - AUTOCYCLE	15 - SEMI-TRACTOR	21 - HEAVY EQUIPMENT	26 - BICYCLE																														
5 - CARGO VAN	10 - MOPED OR MOTORIZED BICYCLE	16 - FARM EQUIPMENT	22 - ANIMAL WITH RIDER OR ANIMAL-DRAWN VEHICLE	27 - TRAIN																														
	11 - ALL TERRAIN VEHICLE (ATV/UTV)	17 - MOTORHOME	99 - UNKNOWN OR HIT/SKIP																															
# of TRAILING UNITS	<table border="0"> <tr> <td>1 - PASSENGER CAR</td> <td>6 - VAN (9-15 SEATS)</td> <td>12 - GOLF CART</td> <td>18 - LIMO (LIVERY VEHICLE)</td> <td>23 - PEDESTRIAN/SKATER</td> </tr> <tr> <td>2 - PASSENGER VAN (MINIVAN)</td> <td>7 - MOTORCYCLE 2-WHEELED</td> <td>13 - SNOWMOBILE</td> <td>19 - BUS (16+ PASSENGERS)</td> <td>24 - WHEELCHAIR (ANY TYPE)</td> </tr> <tr> <td>3 - SPORT UTILITY VEHICLE</td> <td>8 - MOTORCYCLE 3-WHEELED</td> <td>14 - SINGLE UNIT TRUCK</td> <td>20 - OTHER VEHICLE</td> <td>25 - OTHER NON-MOTORIST</td> </tr> <tr> <td>4 - PICK UP</td> <td>9 - AUTOCYCLE</td> <td>15 - SEMI-TRACTOR</td> <td>21 - HEAVY EQUIPMENT</td> <td>26 - BICYCLE</td> </tr> <tr> <td>5 - CARGO VAN</td> <td>10 - MOPED OR MOTORIZED BICYCLE</td> <td>16 - FARM EQUIPMENT</td> <td>22 - ANIMAL WITH RIDER OR ANIMAL-DRAWN VEHICLE</td> <td>27 - TRAIN</td> </tr> <tr> <td></td> <td>11 - ALL TERRAIN VEHICLE (ATV/UTV)</td> <td>17 - MOTORHOME</td> <td>99 - UNKNOWN OR HIT/SKIP</td> <td></td> </tr> </table>				1 - PASSENGER CAR	6 - VAN (9-15 SEATS)	12 - GOLF CART	18 - LIMO (LIVERY VEHICLE)	23 - PEDESTRIAN/SKATER	2 - PASSENGER VAN (MINIVAN)	7 - MOTORCYCLE 2-WHEELED	13 - SNOWMOBILE	19 - BUS (16+ PASSENGERS)	24 - WHEELCHAIR (ANY TYPE)	3 - SPORT UTILITY VEHICLE	8 - MOTORCYCLE 3-WHEELED	14 - SINGLE UNIT TRUCK	20 - OTHER VEHICLE	25 - OTHER NON-MOTORIST	4 - PICK UP	9 - AUTOCYCLE	15 - SEMI-TRACTOR	21 - HEAVY EQUIPMENT	26 - BICYCLE	5 - CARGO VAN	10 - MOPED OR MOTORIZED BICYCLE	16 - FARM EQUIPMENT	22 - ANIMAL WITH RIDER OR ANIMAL-DRAWN VEHICLE	27 - TRAIN		11 - ALL TERRAIN VEHICLE (ATV/UTV)	17 - MOTORHOME	99 - UNKNOWN OR HIT/SKIP	
1 - PASSENGER CAR	6 - VAN (9-15 SEATS)	12 - GOLF CART	18 - LIMO (LIVERY VEHICLE)	23 - PEDESTRIAN/SKATER																														
2 - PASSENGER VAN (MINIVAN)	7 - MOTORCYCLE 2-WHEELED	13 - SNOWMOBILE	19 - BUS (16+ PASSENGERS)	24 - WHEELCHAIR (ANY TYPE)																														
3 - SPORT UTILITY VEHICLE	8 - MOTORCYCLE 3-WHEELED	14 - SINGLE UNIT TRUCK	20 - OTHER VEHICLE	25 - OTHER NON-MOTORIST																														
4 - PICK UP	9 - AUTOCYCLE	15 - SEMI-TRACTOR	21 - HEAVY EQUIPMENT	26 - BICYCLE																														
5 - CARGO VAN	10 - MOPED OR MOTORIZED BICYCLE	16 - FARM EQUIPMENT	22 - ANIMAL WITH RIDER OR ANIMAL-DRAWN VEHICLE	27 - TRAIN																														
	11 - ALL TERRAIN VEHICLE (ATV/UTV)	17 - MOTORHOME	99 - UNKNOWN OR HIT/SKIP																															
VEHICLE MODE WHEN CRASH OCCURRED? 2	<table border="0"> <tr> <td>0 - NO AUTOMATION</td> <td>3 - CONDITIONAL AUTOMATION</td> <td>9 - OTHER/UNKNOWN</td> </tr> <tr> <td>1 - DRIVER ASSISTANCE</td> <td>4 - HIGH AUTOMATION</td> <td></td> </tr> <tr> <td>2 - PARTIAL AUTOMATION</td> <td>5 - FULL AUTOMATION</td> <td></td> </tr> </table>				0 - NO AUTOMATION	3 - CONDITIONAL AUTOMATION	9 - OTHER/UNKNOWN	1 - DRIVER ASSISTANCE	4 - HIGH AUTOMATION		2 - PARTIAL AUTOMATION	5 - FULL AUTOMATION																						
0 - NO AUTOMATION	3 - CONDITIONAL AUTOMATION	9 - OTHER/UNKNOWN																																
1 - DRIVER ASSISTANCE	4 - HIGH AUTOMATION																																	
2 - PARTIAL AUTOMATION	5 - FULL AUTOMATION																																	
SPECIAL FUNCTION 1	<table border="0"> <tr> <td>1 - NONE</td> <td>6 - BUS - CHARTER/TOUR</td> <td>11 - FIRE</td> <td>16 - FARM</td> <td>21 - MAIL CARRIER</td> </tr> <tr> <td>2 - TAXI</td> <td>7 - BUS - INTERCITY</td> <td>12 - MILITARY</td> <td>17 - MOWING</td> <td>99 - OTHER / UNKNOWN</td> </tr> <tr> <td>3 - ELECTRONIC RIDE SHARING</td> <td>8 - BUS - SHUTTLE</td> <td>13 - POLICE</td> <td>18 - SNOW REMOVAL</td> <td></td> </tr> <tr> <td>4 - SCHOOL TRANSPORT</td> <td>9 - BUS - OTHER</td> <td>14 - PUBLIC UTILITY</td> <td>19 - TOWING</td> <td></td> </tr> <tr> <td>5 - BUS - TRANSIT/COMMUTER</td> <td>10 - AMBULANCE</td> <td>15 - CONSTRUCTION EQUIP.</td> <td>20 - SAFETY SERVICE PATROL</td> <td></td> </tr> </table>				1 - NONE	6 - BUS - CHARTER/TOUR	11 - FIRE	16 - FARM	21 - MAIL CARRIER	2 - TAXI	7 - BUS - INTERCITY	12 - MILITARY	17 - MOWING	99 - OTHER / UNKNOWN	3 - ELECTRONIC RIDE SHARING	8 - BUS - SHUTTLE	13 - POLICE	18 - SNOW REMOVAL		4 - SCHOOL TRANSPORT	9 - BUS - OTHER	14 - PUBLIC UTILITY	19 - TOWING		5 - BUS - TRANSIT/COMMUTER	10 - AMBULANCE	15 - CONSTRUCTION EQUIP.	20 - SAFETY SERVICE PATROL						
1 - NONE	6 - BUS - CHARTER/TOUR	11 - FIRE	16 - FARM	21 - MAIL CARRIER																														
2 - TAXI	7 - BUS - INTERCITY	12 - MILITARY	17 - MOWING	99 - OTHER / UNKNOWN																														
3 - ELECTRONIC RIDE SHARING	8 - BUS - SHUTTLE	13 - POLICE	18 - SNOW REMOVAL																															
4 - SCHOOL TRANSPORT	9 - BUS - OTHER	14 - PUBLIC UTILITY	19 - TOWING																															
5 - BUS - TRANSIT/COMMUTER	10 - AMBULANCE	15 - CONSTRUCTION EQUIP.	20 - SAFETY SERVICE PATROL																															
CARGO BODY TYPE 1	<table border="0"> <tr> <td>1 - NO CARGO BODY TYPE / NOT APPLICABLE</td> <td>4 - LOGGING</td> <td>7 - GRAIN/CHIPS/GRAVEL</td> <td>11 - DUMP</td> <td>99 - OTHER / UNKNOWN</td> </tr> <tr> <td>2 - BUS</td> <td>5 - INTERMODAL CONTAINER CHASSIS</td> <td>8 - POLE</td> <td>12 - CONCRETE MIXER</td> <td></td> </tr> <tr> <td>3 - VEHICLE TOWING ANOTHER MOTOR VEHICLE</td> <td>6 - CARGOVAN /ENCLOSED BOX</td> <td>9 - CARGO TANK</td> <td>13 - AUTO TRANSPORTER</td> <td></td> </tr> <tr> <td></td> <td></td> <td>10 - FLAT BED</td> <td>14 - GARBAGE/REFUSE</td> <td></td> </tr> </table>				1 - NO CARGO BODY TYPE / NOT APPLICABLE	4 - LOGGING	7 - GRAIN/CHIPS/GRAVEL	11 - DUMP	99 - OTHER / UNKNOWN	2 - BUS	5 - INTERMODAL CONTAINER CHASSIS	8 - POLE	12 - CONCRETE MIXER		3 - VEHICLE TOWING ANOTHER MOTOR VEHICLE	6 - CARGOVAN /ENCLOSED BOX	9 - CARGO TANK	13 - AUTO TRANSPORTER				10 - FLAT BED	14 - GARBAGE/REFUSE											
1 - NO CARGO BODY TYPE / NOT APPLICABLE	4 - LOGGING	7 - GRAIN/CHIPS/GRAVEL	11 - DUMP	99 - OTHER / UNKNOWN																														
2 - BUS	5 - INTERMODAL CONTAINER CHASSIS	8 - POLE	12 - CONCRETE MIXER																															
3 - VEHICLE TOWING ANOTHER MOTOR VEHICLE	6 - CARGOVAN /ENCLOSED BOX	9 - CARGO TANK	13 - AUTO TRANSPORTER																															
		10 - FLAT BED	14 - GARBAGE/REFUSE																															
VEHICLE DEFECTS	<table border="0"> <tr> <td>1 - TURN SIGNALS</td> <td>4 - BRAKES</td> <td>7 - WORN OR SLICK TIRES</td> <td>9 - MOTOR TROUBLE</td> <td>99 - OTHER / UNKNOWN</td> </tr> <tr> <td>2 - HEAD LAMPS</td> <td>5 - STEERING</td> <td>8 - TRAILER EQUIPMENT DEFECTIVE</td> <td>10 - DISABLED FROM PRIOR ACCIDENT</td> <td></td> </tr> <tr> <td>3 - TAIL LAMPS</td> <td>6 - TIRE BLOWOUT</td> <td></td> <td></td> <td></td> </tr> </table>				1 - TURN SIGNALS	4 - BRAKES	7 - WORN OR SLICK TIRES	9 - MOTOR TROUBLE	99 - OTHER / UNKNOWN	2 - HEAD LAMPS	5 - STEERING	8 - TRAILER EQUIPMENT DEFECTIVE	10 - DISABLED FROM PRIOR ACCIDENT		3 - TAIL LAMPS	6 - TIRE BLOWOUT																		
1 - TURN SIGNALS	4 - BRAKES	7 - WORN OR SLICK TIRES	9 - MOTOR TROUBLE	99 - OTHER / UNKNOWN																														
2 - HEAD LAMPS	5 - STEERING	8 - TRAILER EQUIPMENT DEFECTIVE	10 - DISABLED FROM PRIOR ACCIDENT																															
3 - TAIL LAMPS	6 - TIRE BLOWOUT																																	

NON-MOTORIST LOCATION AT IMPACT	<table border="0"> <tr> <td>1 - INTERSECTION - MARKED CROSSWALK</td> <td>4 - MIDBLOCK - MARKED CROSSWALK</td> <td>7 - SHOULDER/ROADSIDE</td> <td>10 - DRIVEWAY ACCESS</td> <td>99 - OTHER / UNKNOWN</td> </tr> <tr> <td>2 - INTERSECTION - UNMARKED CROSSWALK</td> <td>5 - TRAVEL LANE - OTHER LOCATION</td> <td>8 - SIDEWALK</td> <td>11 - SHARED USE PATHS OR TRAILS</td> <td></td> </tr> <tr> <td>3 - INTERSECTION - OTHER</td> <td>6 - BICYCLE LANE</td> <td>9 - MEDIAN/CROSSING ISLAND</td> <td>12 - FIRST RESPONDER AT INCIDENT SCENE</td> <td></td> </tr> </table>				1 - INTERSECTION - MARKED CROSSWALK	4 - MIDBLOCK - MARKED CROSSWALK	7 - SHOULDER/ROADSIDE	10 - DRIVEWAY ACCESS	99 - OTHER / UNKNOWN	2 - INTERSECTION - UNMARKED CROSSWALK	5 - TRAVEL LANE - OTHER LOCATION	8 - SIDEWALK	11 - SHARED USE PATHS OR TRAILS		3 - INTERSECTION - OTHER	6 - BICYCLE LANE	9 - MEDIAN/CROSSING ISLAND	12 - FIRST RESPONDER AT INCIDENT SCENE																										
1 - INTERSECTION - MARKED CROSSWALK	4 - MIDBLOCK - MARKED CROSSWALK	7 - SHOULDER/ROADSIDE	10 - DRIVEWAY ACCESS	99 - OTHER / UNKNOWN																																								
2 - INTERSECTION - UNMARKED CROSSWALK	5 - TRAVEL LANE - OTHER LOCATION	8 - SIDEWALK	11 - SHARED USE PATHS OR TRAILS																																									
3 - INTERSECTION - OTHER	6 - BICYCLE LANE	9 - MEDIAN/CROSSING ISLAND	12 - FIRST RESPONDER AT INCIDENT SCENE																																									
ACTION 3	<table border="0"> <tr> <td>1 - NON-CONTACT</td> <td>1 - STRAIGHT AHEAD</td> <td>9 - LEAVING TRAFFIC LANE</td> <td>15 - WALKING, RUNNING, JOGGING, PLAYING</td> <td>21 - STANDING OUTSIDE DISABLED VEHICLE</td> </tr> <tr> <td>2 - NON-COLLISION</td> <td>2 - BACKING</td> <td>10 - PARKED</td> <td>16 - WORKING</td> <td>99 - OTHER / UNKNOWN</td> </tr> <tr> <td>3 - STRIKING</td> <td>3 - CHANGING LANES</td> <td>11 - SLOWING OR STOPPED IN TRAFFIC</td> <td>17 - PUSHING VEHICLE</td> <td></td> </tr> <tr> <td>4 - STRUCK</td> <td>4 - OVERTAKING/PASSING</td> <td>12 - DRIVERLESS</td> <td>18 - APPROACHING OR LEAVING VEHICLE</td> <td></td> </tr> <tr> <td>5 - BOTH STRIKING & STRUCK</td> <td>5 - MAKING RIGHT TURN</td> <td>13 - NEGOTIATING A CURVE</td> <td>19 - STANDING</td> <td></td> </tr> <tr> <td>9 - OTHER / UNKNOWN</td> <td>6 - MAKING LEFT TURN</td> <td>14 - ENTERING OR CROSSING SPECIFIED LOCATION</td> <td>20 - OTHER NON-MOTORIST</td> <td></td> </tr> <tr> <td></td> <td>7 - MAKING U-TURN</td> <td></td> <td></td> <td></td> </tr> <tr> <td></td> <td>8 - ENTERING TRAFFIC LANE</td> <td></td> <td></td> <td></td> </tr> </table>				1 - NON-CONTACT	1 - STRAIGHT AHEAD	9 - LEAVING TRAFFIC LANE	15 - WALKING, RUNNING, JOGGING, PLAYING	21 - STANDING OUTSIDE DISABLED VEHICLE	2 - NON-COLLISION	2 - BACKING	10 - PARKED	16 - WORKING	99 - OTHER / UNKNOWN	3 - STRIKING	3 - CHANGING LANES	11 - SLOWING OR STOPPED IN TRAFFIC	17 - PUSHING VEHICLE		4 - STRUCK	4 - OVERTAKING/PASSING	12 - DRIVERLESS	18 - APPROACHING OR LEAVING VEHICLE		5 - BOTH STRIKING & STRUCK	5 - MAKING RIGHT TURN	13 - NEGOTIATING A CURVE	19 - STANDING		9 - OTHER / UNKNOWN	6 - MAKING LEFT TURN	14 - ENTERING OR CROSSING SPECIFIED LOCATION	20 - OTHER NON-MOTORIST			7 - MAKING U-TURN					8 - ENTERING TRAFFIC LANE			
1 - NON-CONTACT	1 - STRAIGHT AHEAD	9 - LEAVING TRAFFIC LANE	15 - WALKING, RUNNING, JOGGING, PLAYING	21 - STANDING OUTSIDE DISABLED VEHICLE																																								
2 - NON-COLLISION	2 - BACKING	10 - PARKED	16 - WORKING	99 - OTHER / UNKNOWN																																								
3 - STRIKING	3 - CHANGING LANES	11 - SLOWING OR STOPPED IN TRAFFIC	17 - PUSHING VEHICLE																																									
4 - STRUCK	4 - OVERTAKING/PASSING	12 - DRIVERLESS	18 - APPROACHING OR LEAVING VEHICLE																																									
5 - BOTH STRIKING & STRUCK	5 - MAKING RIGHT TURN	13 - NEGOTIATING A CURVE	19 - STANDING																																									
9 - OTHER / UNKNOWN	6 - MAKING LEFT TURN	14 - ENTERING OR CROSSING SPECIFIED LOCATION	20 - OTHER NON-MOTORIST																																									
	7 - MAKING U-TURN																																											
	8 - ENTERING TRAFFIC LANE																																											
CONTRIBUTING CIRCUMSTANCES 11	<table border="0"> <tr> <td>1 - NONE</td> <td>8 - FOLLOWING TOO CLOSE /ACDA</td> <td>13 - IMPROPER START FROM A PARKED POSITION</td> <td>18 - OPERATING DEFECTIVE EQUIPMENT</td> <td>23 - OPENING DOOR INTO ROADWAY</td> </tr> <tr> <td>2 - FAILURE TO YIELD</td> <td>9 - IMPROPER LANE CHANGE</td> <td>14 - STOPPED OR PARKED ILLEGALLY</td> <td>19 - LOAD SHIFTING /FALLING/SPILLING</td> <td>99 - OTHER IMPROPER ACTION</td> </tr> <tr> <td>3 - RAN RED LIGHT</td> <td>10 - IMPROPER PASSING</td> <td>15 - SWERVING TO AVOID</td> <td>20 - IMPROPER CROSSING</td> <td></td> </tr> <tr> <td>4 - RAN STOP SIGN</td> <td>11 - DROVE OFF ROAD</td> <td>16 - WRONG WAY</td> <td>21 - LYING IN ROADWAY</td> <td></td> </tr> <tr> <td>5 - UNSAFE SPEED</td> <td>12 - IMPROPER BACKING</td> <td>17 - VISION OBSTRUCTION</td> <td>22 - NOT DISCERNIBLE</td> <td></td> </tr> <tr> <td>6 - IMPROPER TURN</td> <td></td> <td></td> <td></td> <td></td> </tr> <tr> <td>7 - LEFT OF CENTER</td> <td></td> <td></td> <td></td> <td></td> </tr> </table>				1 - NONE	8 - FOLLOWING TOO CLOSE /ACDA	13 - IMPROPER START FROM A PARKED POSITION	18 - OPERATING DEFECTIVE EQUIPMENT	23 - OPENING DOOR INTO ROADWAY	2 - FAILURE TO YIELD	9 - IMPROPER LANE CHANGE	14 - STOPPED OR PARKED ILLEGALLY	19 - LOAD SHIFTING /FALLING/SPILLING	99 - OTHER IMPROPER ACTION	3 - RAN RED LIGHT	10 - IMPROPER PASSING	15 - SWERVING TO AVOID	20 - IMPROPER CROSSING		4 - RAN STOP SIGN	11 - DROVE OFF ROAD	16 - WRONG WAY	21 - LYING IN ROADWAY		5 - UNSAFE SPEED	12 - IMPROPER BACKING	17 - VISION OBSTRUCTION	22 - NOT DISCERNIBLE		6 - IMPROPER TURN					7 - LEFT OF CENTER									
1 - NONE	8 - FOLLOWING TOO CLOSE /ACDA	13 - IMPROPER START FROM A PARKED POSITION	18 - OPERATING DEFECTIVE EQUIPMENT	23 - OPENING DOOR INTO ROADWAY																																								
2 - FAILURE TO YIELD	9 - IMPROPER LANE CHANGE	14 - STOPPED OR PARKED ILLEGALLY	19 - LOAD SHIFTING /FALLING/SPILLING	99 - OTHER IMPROPER ACTION																																								
3 - RAN RED LIGHT	10 - IMPROPER PASSING	15 - SWERVING TO AVOID	20 - IMPROPER CROSSING																																									
4 - RAN STOP SIGN	11 - DROVE OFF ROAD	16 - WRONG WAY	21 - LYING IN ROADWAY																																									
5 - UNSAFE SPEED	12 - IMPROPER BACKING	17 - VISION OBSTRUCTION	22 - NOT DISCERNIBLE																																									
6 - IMPROPER TURN																																												
7 - LEFT OF CENTER																																												

SEQUENCE OF EVENTS	<table border="0"> <tr> <td>1 - OVERTURN/ROLLOVER</td> <td>7 - SEPARATION OF UNITS</td> <td>12 - DOWNHILL RUNAWAY</td> <td>19 - ANIMAL - OTHER</td> <td>23 - STRUCK BY FALLING, SHIFTING CARGO OR ANYTHING SET IN MOTION BY A MOTOR VEHICLE</td> </tr> <tr> <td>2 - FIRE/EXPLOSION</td> <td>8 - RAN OFF ROAD RIGHT</td> <td>13 - OTHER NON-COLLISION</td> <td>20 - MOTOR VEHICLE IN TRANSPORT</td> <td>24 - OTHER MOVABLE OBJECT</td> </tr> <tr> <td>3 - IMMERSION</td> <td>9 - RAN OFF ROAD LEFT</td> <td>14 - PEDESTRIAN</td> <td>21 - PARKED MOTOR VEHICLE</td> <td></td> </tr> <tr> <td>4 - JACKKNIFE</td> <td>10 - CROSS MEDIAN</td> <td>15 - PEDALCYCLE</td> <td>22 - WORK ZONE MAINTENANCE EQUIPMENT</td> <td></td> </tr> <tr> <td>5 - CARGO / EQUIPMENT LOSS OR SHIFT</td> <td>11 - CROSS CENTERLINE - OPPOSITE DIRECTION OF TRAVEL</td> <td>16 - RAILWAY VEHICLE</td> <td></td> <td></td> </tr> <tr> <td>6 - EQUIPMENT FAILURE</td> <td></td> <td>17 - ANIMAL - FARM</td> <td></td> <td></td> </tr> <tr> <td></td> <td></td> <td>18 - ANIMAL - DEER</td> <td></td> <td></td> </tr> </table>				1 - OVERTURN/ROLLOVER	7 - SEPARATION OF UNITS	12 - DOWNHILL RUNAWAY	19 - ANIMAL - OTHER	23 - STRUCK BY FALLING, SHIFTING CARGO OR ANYTHING SET IN MOTION BY A MOTOR VEHICLE	2 - FIRE/EXPLOSION	8 - RAN OFF ROAD RIGHT	13 - OTHER NON-COLLISION	20 - MOTOR VEHICLE IN TRANSPORT	24 - OTHER MOVABLE OBJECT	3 - IMMERSION	9 - RAN OFF ROAD LEFT	14 - PEDESTRIAN	21 - PARKED MOTOR VEHICLE		4 - JACKKNIFE	10 - CROSS MEDIAN	15 - PEDALCYCLE	22 - WORK ZONE MAINTENANCE EQUIPMENT		5 - CARGO / EQUIPMENT LOSS OR SHIFT	11 - CROSS CENTERLINE - OPPOSITE DIRECTION OF TRAVEL	16 - RAILWAY VEHICLE			6 - EQUIPMENT FAILURE		17 - ANIMAL - FARM					18 - ANIMAL - DEER		
1 - OVERTURN/ROLLOVER	7 - SEPARATION OF UNITS	12 - DOWNHILL RUNAWAY	19 - ANIMAL - OTHER	23 - STRUCK BY FALLING, SHIFTING CARGO OR ANYTHING SET IN MOTION BY A MOTOR VEHICLE																																			
2 - FIRE/EXPLOSION	8 - RAN OFF ROAD RIGHT	13 - OTHER NON-COLLISION	20 - MOTOR VEHICLE IN TRANSPORT	24 - OTHER MOVABLE OBJECT																																			
3 - IMMERSION	9 - RAN OFF ROAD LEFT	14 - PEDESTRIAN	21 - PARKED MOTOR VEHICLE																																				
4 - JACKKNIFE	10 - CROSS MEDIAN	15 - PEDALCYCLE	22 - WORK ZONE MAINTENANCE EQUIPMENT																																				
5 - CARGO / EQUIPMENT LOSS OR SHIFT	11 - CROSS CENTERLINE - OPPOSITE DIRECTION OF TRAVEL	16 - RAILWAY VEHICLE																																					
6 - EQUIPMENT FAILURE		17 - ANIMAL - FARM																																					
		18 - ANIMAL - DEER																																					
FIRST HARMFUL EVENT 1	MOST HARMFUL EVENT 1																																						
COLLISION WITH FIXED OBJECT - STRUCK																																							
25 - IMPACT ATTENUATOR / CRASH CUSHION	31 - GUARDRAIL END	38 - OVERHEAD SIGN POST	45 - EMBANKMENT	52 - BUILDING																																			
26 - BRIDGE OVERHEAD STRUCTURE	32 - PORTABLE BARRIER	39 - LIGHT / LUMINARIES SUPPORT	46 - FENCE	53 - TUNNEL																																			
27 - BRIDGE PIER OR ABUTMENT	33 - MEDIAN CABLE BARRIER	40 - UTILITY POLE	47 - MAILBOX	54 - OTHER FIXED OBJECT																																			
28 - BRIDGE PARAPET	34 - MEDIAN GUARDRAIL BARRIER	41 - OTHER POST, POLE OR SUPPORT	48 - TREE	99 - OTHER / UNKNOWN																																			
29 - BRIDGE RAIL	35 - MEDIAN CONCRETE BARRIER	42 - CULVERT	49 - FIRE HYDRANT																																				
30 - GUARDRAIL FACE	36 - MEDIAN OTHER BARRIER	43 - CURB	50 - WORK ZONE MAINTENANCE EQUIPMENT																																				
	37 - TRAFFIC SIGN POST	44 - DITCH	51 - WALL																																				

LOCAL REPORT NUMBER 2025000000565													
DAMAGE													
DAMAGE SCALE													
<table border="0"> <tr> <td>1 - NONE</td> <td>3 - FUNCTIONAL DAMAGE</td> </tr> <tr> <td>4 - MINOR DAMAGE</td> <td>4 - DISABLING DAMAGE</td> </tr> <tr> <td colspan="2">9 - UNKNOWN</td> </tr> </table>		1 - NONE	3 - FUNCTIONAL DAMAGE	4 - MINOR DAMAGE	4 - DISABLING DAMAGE	9 - UNKNOWN							
1 - NONE	3 - FUNCTIONAL DAMAGE												
4 - MINOR DAMAGE	4 - DISABLING DAMAGE												
9 - UNKNOWN													
DAMAGED AREA(S) INDICATE ALL THAT APPLY													
<input type="checkbox"/> NO DAMAGE [0] <input type="checkbox"/> UNDERCARRIAGE [14] <input type="checkbox"/> TOP [13] <input type="checkbox"/> ALL AREAS [15] <input type="checkbox"/> UNIT NOT AT SCENE [16]													
INITIAL POINT OF CONTACT													
<table border="0"> <tr> <td>0 - NO DAMAGE</td> <td>14 - UNDERCARRIAGE</td> </tr> <tr> <td>1-12 - REFER TO UNIT DIAGRAM</td> <td>15 - VEHICLE NOT AT SCENE</td> </tr> <tr> <td colspan="2">99 - UNKNOWN</td> </tr> </table>		0 - NO DAMAGE	14 - UNDERCARRIAGE	1-12 - REFER TO UNIT DIAGRAM	15 - VEHICLE NOT AT SCENE	99 - UNKNOWN							
0 - NO DAMAGE	14 - UNDERCARRIAGE												
1-12 - REFER TO UNIT DIAGRAM	15 - VEHICLE NOT AT SCENE												
99 - UNKNOWN													
TRAFFIC													
TRAFFICWAY FLOW 2	TRAFFIC CONTROL 6												
# OF THROUGH LANES ON ROAD 2	RAIL GRADE CROSSING 1												
UNIT / NON-MOTORIST DIRECTION													
<table border="0"> <tr> <td>FROM 3</td> <td>TO</td> </tr> <tr> <td>1 - NORTH</td> <td>5 - NORTHEAST</td> </tr> <tr> <td>2 - SOUTH</td> <td>6 - NORTHWEST</td> </tr> <tr> <td>3 - EAST</td> <td>7 - SOUTHEAST</td> </tr> <tr> <td>4 - WEST</td> <td>8 - SOUTHWEST</td> </tr> <tr> <td colspan="2">9 - OTHER / UNKNOWN</td> </tr> </table>		FROM 3	TO	1 - NORTH	5 - NORTHEAST	2 - SOUTH	6 - NORTHWEST	3 - EAST	7 - SOUTHEAST	4 - WEST	8 - SOUTHWEST	9 - OTHER / UNKNOWN	
FROM 3	TO												
1 - NORTH	5 - NORTHEAST												
2 - SOUTH	6 - NORTHWEST												
3 - EAST	7 - SOUTHEAST												
4 - WEST	8 - SOUTHWEST												
9 - OTHER / UNKNOWN													
UNIT SPEED 55	DETECTED SPEED 1 - STATED / ESTIMATED SPEED												
POSTED SPEED 55	2 - CALCULATED / EDR 3 - UNDETERMINED												

OCCUPANT / WITNESS ADDENDUM

LOCAL REPORT NUMBER
2025000000565

OCCUPANT	UNIT # 1	NAME: LAST, FIRST, MIDDLE HICKS, ASHTON				DATE OF BIRTH 04/14/2009		AGE 15	GENDER M	
	ADDRESS: STREET, CITY, STATE, ZIP 7038 BIGGERT RD, LONDON, OH, 43140					CONTACT PHONE - INCLUDE AREA CODE				
	INJURIES 5	INJURED TAKEN BY 1	EMS AGENCY (NAME) PRAIRIE TOWNSHIP EMS	INJURED TAKEN TO: MEDICAL FACILITY (NAME, CITY)	SAFETY EQUIPMENT 1	<input type="checkbox"/> DOT-COMPLIANT MC HELMET	SEATING POSITION 3	AIR BAG USAGE 2	EJECTION 1	TRAPPED 1

OCCUPANT	UNIT #	NAME: LAST, FIRST, MIDDLE				DATE OF BIRTH		AGE	GENDER	
	ADDRESS: STREET, CITY, STATE, ZIP					CONTACT PHONE - INCLUDE AREA CODE				
	INJURIES	INJURED TAKEN BY	EMS AGENCY (NAME)	INJURED TAKEN TO: MEDICAL FACILITY (NAME, CITY)	SAFETY EQUIPMENT	<input type="checkbox"/> DOT-COMPLIANT MC HELMET	SEATING POSITION	AIR BAG USAGE	EJECTION	TRAPPED

OCCUPANT	UNIT #	NAME: LAST, FIRST, MIDDLE				DATE OF BIRTH		AGE	GENDER	
	ADDRESS: STREET, CITY, STATE, ZIP					CONTACT PHONE - INCLUDE AREA CODE				
	INJURIES	INJURED TAKEN BY	EMS AGENCY (NAME)	INJURED TAKEN TO: MEDICAL FACILITY (NAME, CITY)	SAFETY EQUIPMENT	<input type="checkbox"/> DOT-COMPLIANT MC HELMET	SEATING POSITION	AIR BAG USAGE	EJECTION	TRAPPED

OCCUPANT	UNIT #	NAME: LAST, FIRST, MIDDLE				DATE OF BIRTH		AGE	GENDER	
	ADDRESS: STREET, CITY, STATE, ZIP					CONTACT PHONE - INCLUDE AREA CODE				
	INJURIES	INJURED TAKEN BY	EMS AGENCY (NAME)	INJURED TAKEN TO: MEDICAL FACILITY (NAME, CITY)	SAFETY EQUIPMENT	<input type="checkbox"/> DOT-COMPLIANT MC HELMET	SEATING POSITION	AIR BAG USAGE	EJECTION	TRAPPED

INJURIES	SAFETY EQUIPMENT USED	SEATING POSITION	AIR BAG USAGE
1 - FATAL 2 - SUSPECTED SERIOUS INJURY 3 - SUSPECTED MINOR INJURY 4 - POSSIBLE INJURY 5 - NO APPARENT INJURY	1 - NONE USED - VEHICLE OCCUPANT 2 - SHOULDER BELT ONLY USED 3 - LAP BELT ONLY USED 4 - SHOULDER & LAP BELT USED 5 - CHILD RESTRAINT SYSTEM - FORWARD FACING 6 - CHILD RESTRAINT SYSTEM - REAR FACING 7 - BOOSTER SEAT 8 - HELMET USED 9 - PROTECTIVE PADS USED (ELBOWS, KNEES, ETC) 10 - REFLECTIVE CLOTHING 11 - LIGHTING - PEDESTRIAN / BICYCLE ONLY 99 - OTHER / UNKNOWN	1 - FRONT - LEFT SIDE (MOTORCYCLE DRIVER) 2 - FRONT - MIDDLE 3 - FRONT - RIGHT SIDE 4 - SECOND - LEFT SIDE (MOTORCYCLE PASSENGER) 5 - SECOND - MIDDLE 6 - SECOND - RIGHT SIDE 7 - THIRD - LEFT SIDE (MOTORCYCLE SIDE CAR) 8 - THIRD - MIDDLE 9 - THIRD - RIGHT SIDE 10 - SLEEPER SECTION OF TRUCK CAB 11 - PASSENGER IN OTHER ENCLOSED CARGO AREA (NON-TRAILING UNIT SUCH AS A BUS, PICK-UP WITH CAP) 12 - PASSENGER IN UNENCLOSED CARGO AREA 13 - TRAILING UNIT 14 - RIDING ON VEHICLE EXTERIOR (NON-TRAILING UNIT) 15 - NON-MOTORIST 99 - OTHER / UNKNOWN	1 - NOT DEPLOYED 2 - DEPLOYED FRONT 3 - DEPLOYED SIDE 4 - DEPLOYED BOTH FRONT/SIDE 5 - NOT APPLICABLE 9 - DEPLOYMENT UNKNOWN
INJURED TAKEN BY			EJECTION
1 - NOT TRANSPORTED / TREATED AT SCENE 2 - EMS 3 - POLICE 9 - OTHER / UNKNOWN			1 - NOT EJECTED 2 - PARTIALLY EJECTED 3 - TOTALLY EJECTED 4 - NOT APPLICABLE
GENDER			TRAPPED
F - FEMALE M - MALE U - OTHER / UNKNOWN			1 - NOT TRAPPED 2 - EXTRICATED BY MECHANICAL MEANS 3 - FREED BY NON-MECHANICAL MEANS

WITNESS	NAME: LAST, FIRST, MIDDLE				DATE OF BIRTH		AGE	GENDER	
	ADDRESS: STREET, CITY, STATE, ZIP					CONTACT PHONE - INCLUDE AREA CODE			

WITNESS	NAME: LAST, FIRST, MIDDLE				DATE OF BIRTH		AGE	GENDER	
	ADDRESS: STREET, CITY, STATE, ZIP					CONTACT PHONE - INCLUDE AREA CODE			

WITNESS	NAME: LAST, FIRST, MIDDLE				DATE OF BIRTH		AGE	GENDER	
	ADDRESS: STREET, CITY, STATE, ZIP					CONTACT PHONE - INCLUDE AREA CODE			