

KENY BOULEVARD
LONDON, OHIO

→ To old address Mt. St. Mary road due to curve

1/20/96
2600' of water
370' of water
1800'
2370'
2370' of water

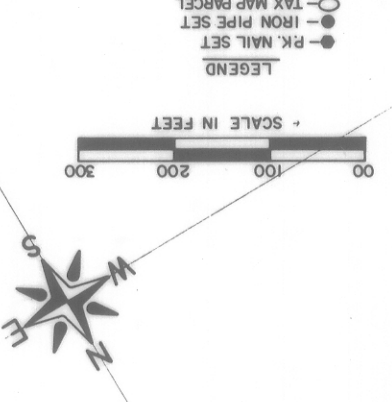

PLAT SHOWING A LAND SURVEY OF A 97.2603 AC. TRACT
AND A 8.7873 AC. TRACT AS RECORDED IN DEED BOOK 277,
PAGE 299 IN THE NAME OF INTERNATIONAL PRESSURE
SERVICE, INC. SITUATED IN THE STATE OF OHIO, COUNTY OF
MADISON, CITY OF LONDON, V.M.S. 5801.

1 FOOT CONTOUR MAP
MAY 1988

7/7